



HILLINGDON
LONDON



NOTICE OF HEARING

Licensing Sub-Committee

Date: THURSDAY 23
NOVEMBER 2023

Time: 10:00

Venue: COMMITTEE ROOM 6,
CIVIC CENTRE, HIGH
STREET, UXBRIDGE, UB8
1UW

Meeting Details: Members of the Public and Media are welcome to attend. This meeting may also be broadcast live.

If this is a public hearing, the agenda is available online at www.hillingdon.gov.uk or you can use a smart phone camera and scan the code below:



Councillors on the Sub-Committee:

Councillor Roy Chamdal (Chairman)
Councillor Becky Haggart OBE
Councillor Janet Gardner

IMPORTANT INFORMATION

On receipt of this notice, you **MUST** notify the Committee Clerk (contact details below) by the following date:

Tuesday 23 November 2023

If you don't notify you may lose your right to speak at the hearing. When notifying you must confirm:

- 1) Whether you intend to attend or to be represented by someone at the hearing;
- 2) If you consider a hearing to be unnecessary and;
- 3) Whether to request that another person attends (other than your representative) as a witness

Published: Wednesday, 8 November 2023

Contact: Ryan Dell

Email: democratic@hillington.gov.uk

Putting our residents first

Lloyd White
Head of Democratic Services
London Borough of Hillingdon,
Phase II, Civic Centre, High Street, Uxbridge, UB8 1UW

Useful information for residents and visitors

Watching & recording this meeting (if a public meeting only)

If this meeting is to be held in Public (Part 1) you can watch it on the Council's YouTube channel, live or archived after the meeting. Residents and the media are also welcome to attend in person, and if they wish, report on the public part of the meeting. Any individual or organisation may record or film proceedings as long as it does not disrupt proceedings.

Watch a **LIVE** broadcast of this meeting on the Council's YouTube Channel: *Hillingdon London*

Those attending should be aware that the Council will film and record proceedings for both official record and resident digital engagement in democracy.



It is recommended to give advance notice of filming to ensure any particular requirements can be met. The Council will provide seating areas for residents/public, high speed WiFi access to all attending and an area for the media to report. The officer shown on the front of this agenda should be contacted for further information and will be available to assist. When present in the room, silent mode should be enabled for all mobile devices.

Travel and parking

Bus routes 427, U1, U3, U4 and U7 all stop at the Civic Centre. Uxbridge underground station, with the Piccadilly and Metropolitan lines, is a short walk away. Limited parking is available at the Civic Centre. For details on availability and how to book parking space, please contact Democratic Services:

Please enter via main reception and visit the security desk to sign-in and collect a visitor's pass. You will then be directed to the Committee Room.

Accessibility

For accessibility options regarding this agenda please contact Democratic Services. For those hard of hearing an Induction Loop System is available for use.

Emergency procedures

If there is a FIRE, you will hear a continuous alarm. Please follow the signs to the nearest FIRE EXIT and assemble on the Civic Centre forecourt. Lifts must not be used unless instructed by a Fire Marshal or Security Officer. In the event of a SECURITY INCIDENT, follow instructions issued via the tannoy, a Fire Marshal or a Security Officer. Those unable to evacuate using the stairs, should make their way to the signed refuge locations.



Agenda

CHAIRMAN'S ANNOUNCEMENTS

Hearing Protocol

- 1 Apologies for Absence
- 2 Declarations of interest in matters coming before this meeting
- 3 To confirm that the items of business marked Part I will be considered in Public and items marked Part II will be considered in Private
- 4 Matters that have been notified in advance or urgent

Part I - Members, Public and Press

	Title of Report / Address of application	Ward	Time	Page
5	Application for a new premises licence application - SAKI, 8 Victoria Road, Ruislip.	Ruislip Manor	10am	3 - 66

This page is intentionally left blank

Order of proceedings – application under the Licensing Act 2003

The Chairman of the Sub-Committee will open the hearing by introducing the Councillors, explaining the purpose of the proceedings and the general procedure. The Chairman will then check that there are no additions or alterations to the list of those appearing at the hearing.

Introduction by the Regulatory Services/Licensing Officer



The Applicant / Licence Holder



Responsible Authorities (if present)



Other Parties (residents etc...)



DISCUSSION LED BY THE SUB-COMMITTEE

The Chairman will lead the discussion. This will be a chance for all parties to provide comments on any submissions that have been made to the Sub-Committee.



Closing remarks from each party



Sub-Committee deliberates



Chairman announces the decision

The Council's Regulatory Services/Licensing Officer will introduce the report and will outline the matter before the Sub-Committee, giving any relevant background information. The Sub-Committee may ask questions of the officer.

The Applicant, licence holder or the person representing him/her will be invited to address the Sub-Committee. They will be allowed sufficient time to present his/her case. The Sub-Committee may ask questions.

Responsible Authorities will be invited to address the Sub-Committee and will be allowed sufficient time. The Sub-Committee may ask questions of the Responsible Authorities.

Other parties will be invited to address the Sub-Committee. Where there are a number of parties making similar representations the Chairman will expect the parties to nominate a spokesperson to make the representations and all will be allowed sufficient time. The Sub-Committee may ask questions of the Other Parties.

The Chairman will invite the Responsible Authorities and Other Parties to make brief closing remarks on the application. The Applicant / licence holder makes the final closing remarks.

The Sub-Committee will remain in the room to deliberate and make their decision, with only the Legal Advisor and the Clerk to the Sub-Committee remaining. All others present will be asked to leave the room. If the meeting is being broadcast, any filming will be stopped for this part.

Parties may return to the room when invited to do so and the Chairman will announce the decision. The Chairman will remind the Applicant / licence holder that the decision will be sent to them in writing. There can be no further questions or statements.

This page is intentionally left blank

Agenda Item 5

Application for the grant of a Premises Licence: SAKI, Unit 2, 8 Victoria Road, Ruislip, HA4 0AA

Committee	Licensing Sub-Committee
Officer Contact	Lois King - 01895 277067
Papers with report	Appendix 1 - Application form and plan Appendix 2 - Representations from Responsible Authorities (2A-C) Appendix 3 - Representations from Interested Parties (3A-G) Appendix 4 - Map of the area Appendix 5 - Photos of the premises
Ward name	Ruislip Manor

1.0 SUMMARY

To consider an application for the grant of a new premises licence in respect of SAKI, Unit 2, 8 Victoria Road, Ruislip, HA4 0AA. The application form and plan are appended as **Appendix 1**. The application has attracted three representations from the Responsible Authorities and seven representations from interested parties objecting to the application.

2.0 RECOMMENDATION

That the Licensing Sub-Committee consider the application for the grant of a new premises licence in respect of SAKI, Unit 2, 8 Victoria Road, Ruislip, HA4 0AA.

3.0 APPLICATION

3.1 Licensable Activities

A new premises licence application has been made by Charlotte Elizabeth Atkinson for the licensable activities as outlined in the table below:

3.2 Proposed Hours for Licensable Activities

	Live Music (indoors)	Recorded Music (indoors)	Performances of Dance (indoors)	Late Night Refreshment (indoors)	Sale of Alcohol (on sales only)
Monday	11:00 – 00:00	11:00 – 00:00	11:00 – 00:00	23:00 – 00:00	11:00 – 00:00
Tuesday	11:00 – 00:00	11:00 – 00:00	11:00 – 00:00	23:00 – 00:00	11:00 – 00:00
Wednesday	11:00 – 00:00	11:00 – 00:00	11:00 – 00:00	23:00 – 00:00	11:00 – 00:00
Thursday	11:00 – 00:00	11:00 – 00:00	11:00 – 00:00	23:00 – 00:00	11:00 – 00:00
Friday	11:00 – 01:00	11:00 – 01:00	11:00 – 01:00	23:00 – 01:00	11:00 – 01:00

Saturday	11:00 – 01:00	11:00 – 01:00	11:00 – 01:00	23:00 – 01:00	11:00 – 01:00
Sunday	11:00 – 00:00	11:00 – 00:00	11:00 – 00:00	23:00 – 00:00	11:00 – 00:00

The opening hours of the premises are Sunday to Thursday 11:00 – 00:30 hours and Friday to Saturday 11:00 – 01:30 hours.

3.3 Type of Application Applied For

New Premises Licence application pursuant to s.17 Licensing Act 2003.

3.4 Description of The Premises

The premises is located in a parade which includes JJ Moons and TEN Restaurant. There are other commercial premises in this parade and on the opposite side of the road. There are residential properties above the premises. The units were previously used as a tanning salon and an estate agent. Ruislip Manor underground station is located across the road.

3.5 Other Licensed Premises nearby (shown on a map appended as **Appendix 4**)

Premises	Address	Licensable Activities and Hours
JJ Moons	12 Victoria Road, Ruislip Manor, HA4 0AA	<p>The sale by retail of alcohol (on & off sales)</p> <p>The provision of late-night refreshment</p> <p>The provision of recorded music</p> <p>On Sunday, Monday, Tuesday, Wednesday & Thursday, except Christmas Eve, New Years Eve & Boxing Day, between 09:00 and 00:30 hrs</p> <p>On Friday & Saturday except Christmas Eve, New Years Eve & Boxing Day, between 09:00 and 01:00 hrs</p> <p>On Christmas Eve & Boxing Day between 09:00 and 02:00 hrs</p> <p>On New Years Eve from 09:00 until 09:00 hours on New Years Day</p>

		<p>On the days stated below, an additional hour following the times detailed above:-</p> <p>Burns Night – 25 January Australia Day – 26 January St David’s Day – 1 March St Patrick’s Day – 17 March St George’s Day – 23 April St Andrew’s Day – 30 November</p> <p>On the days stated below, an additional 30 minutes following the times detailed above:- Thursdays preceding Easter Sundays preceding a Bank Holiday</p> <p>Between the hours of 06:00 and 03:00 the following day, on no more than 12 occasions per calendar year, subject to providing the Licensing Service, the Councils Environmental Protection Unit and the Metropolitan Police Service 10 working days notice, and then only on receiving a subsequent ‘CONSENT’ from the Councils Licensing Service, in respect of this agreement to the specified day and/or times applied for.</p> <p>The provision of recorded music is not time restricted</p>
TEN	10 Victoria Road, Ruislip Manor, HA4 0AA	<p>Provision of regulated entertainment: provision of live music Friday and Saturday 23.00 to 23.30 playing recorded music Every day 23.00 to 23.30</p> <p>The sale by retail of alcohol (on & off sales) Every day 12.00 hrs to 23.30 hrs The provision of late-night refreshment: Every day 23.00 hrs to 23.30 hrs</p>

Real Love Lounge	108-110 Pembroke Road, Ruislip Manor, HA4 8NW	Sale by retail of alcohol (on & off sales) From 12.00 hrs until 23.00 hrs everyday
Manor Kebabs	72 Park Way, Ruislip Manor, HA4 8NR	Provision of Late-Night Refreshment Sunday to Wednesday from 23:00 hrs to 00:00 hrs Thursday from 23:00 to 01:00 Friday and Saturday and New Years Eve from 23:00 hrs to 02:00 hrs the following day
The Raj Doot Tandoori Restaurant	59 Windmill Hill, Ruislip Manor, HA4 8PU	The provision of regulated entertainment (indoors only) except films From 11.00 hrs until 00.30 hrs the following day, everyday The provision of Films (indoors) Films 11.00 hrs to 0100 hrs The sale of alcohol by retail (on & off sales) From 11.00 hrs until 01.00 hrs the following day, everyday Late night refreshment (indoors only) From 23.00 until 01.00 hrs the following day, everyday on and off
Summer China	44 Victoria Road, Ruislip Manor, HA4 0AG	Provision of late-night refreshment From 23:00 hrs until 24:00 hrs the following day
Manor News & Sweets	45 Victoria Road, Ruislip Manor, HA4 9AB	Sale by retail of alcohol Monday to Friday 08:00 hrs until 20:00 hrs Saturday to Sunday 07:00 hrs until 20:00 hrs
Oscar Off Licence	43 Victoria Road, Ruislip Manor, HA4 9AB	Sale by retail of alcohol Monday to Saturday 08:00 hrs to 23:00 hrs Sunday 10:00 hrs to 22:30 hrs Good Friday 08:00 hrs to 22:30 hrs

		Christmas Day 12:00 hrs to 15:00 hrs & 19:00 hrs to 22:30 hrs
Budgens	47-49 Victoria Road, Ruislip Manor, HA4 9AB	Sale of alcohol by retail Monday to Sunday 07:00 to 23:00 hrs
Costa Verde Café & Restaurant	33 Victoria Road, Ruislip Manor, HA4 9AB	Late Night Refreshment Sunday between 23:00 and 24:00 Monday to Thursday 23:00 to 01:00 the following day Friday and Saturday 23:00 to 02:00 the following day For occasional private parties from 23:00 to 03:00 the following day The sale of alcohol by retail (on sales only) Sunday 12:00 to 24:00 Monday to Thursday 12:00 to 01:00 the following day Friday and Saturday 12:00 to 02:00 the following day For occasional private parties from 12:00 to 03:00 the following day
Hennessys	36 Victoria Road, Ruislip Manor, HA4 0AG	Sale of alcohol by retail (on & off sales) and regulated entertainment: - Monday to Wednesday from 10.00 hrs to 00.30 hrs the following day Thursday from 10.00 hrs to 01.00 hrs the following day Friday and Saturday from 10.00 hrs to 02.00 hrs the following day Sunday from 10.00 hrs to 01.00 hrs the following day Provision of late-night refreshment Monday to Wednesday from 23.00 hrs to 00.30 hrs the following day Thursday from 23.00 hrs to 01.00 hrs the following day Friday and Saturday from 23.00 hrs to 02.00 hrs the following day Sunday from 23.00 hrs to 01.00 hrs the following day

		<p>An additional hour to those detailed above on the commencement of British Summer-time.</p> <p>An additional hour following those detailed above on:- New Years Day, Burns Night, Valentines Night, St David's Day, 14th March (Commonwealth Day), St George's Day, Easter Sunday, Easter Monday, May Day Bank Holiday Monday, FA Cup final day, Spring Bank Holiday Monday, August Bank Holiday Monday, Halloween, Guy Fawkes Night, St Andrew's Day</p> <p>An additional 2 hours following those detailed above on:- St Patrick's Day, May Day Bank Holiday Sunday, Spring Bank Holiday Sunday, August Bank Holiday Sunday, Christmas Eve, Boxing Day, 28 December, 29 December, 30 December</p> <p>Additional hours to those detailed above for international sporting events subject to 14 days' notice to the Metropolitan Police and the Licensing Authority and a consent from the Metropolitan Police.</p> <p>The sale of alcohol only From 10.00 hours on New Year's Eve to 10.00 hours on New Year's Day</p>
Pizza Hut	30 Victoria Road, Ruislip Manor, HA4 0AB	<p>Provision of Late-Night Refreshment From 23:00 hrs to 00:30 hrs the following day, every day</p>
Mamma Mia Pizza	20 Victoria Road, Ruislip Manor, HA4 0AB	<p>Provision of Late-Night Refreshment Friday and Saturday - 23:00hrs – 03:00hrs</p>

		Sunday to Thursday - 23:00hrs - 02:00hrs
Tam Chicken	15 Victoria Road, Ruislip Manor, HA4 9AA	Provision of Late-Night Refreshment Monday, Tuesday, Wednesday, Thursday, Friday, Saturday and Sunday 23:00 hrs to 03:00 hrs the following day New Years Eve 23:00 hours to 05:00 hours the following day

3.6 Operating Schedule and Conditions

Section 18 of the application form demonstrates the steps the applicant proposes to take to promote the Licensing Objectives. These can be viewed in **Appendix 1**.

4.0 CONSULTATION

4.1 Closing date for representations

1st November 2023.

4.2 Public Notice published in local newspaper

18th October 2023 edition of The Gazette.

5.0 REPRESENTATIONS

5.1 We have received **three** representations from Responsible Authorities

Responsible Authority	Ground for Representation	Appendix
Metropolitan Police Licensing	Prevention of Crime & Disorder Prevention of Public Nuisance	2A
Licensing Authority	Prevention of Crime & Disorder Prevention of Public Nuisance Public Safety	2B
Environmental Protection Team	Prevention of Public Nuisance Prevention of Crime & Disorder	2C

5.2 We have received **seven** representations from Interested Parties:

Interested Parties	Ground for Representation	Appendix
Cllr Douglas Mills	Prevention of Public Nuisance	3A
Conor Donegan	Prevention of Public Nuisance	3B
Marian Mills	Prevention of Public Nuisance	3C
Samir Yanina	Prevention of Public Nuisance Protection of Children from Harm	3D
Emma Flack & Benjamin Raywood	Prevention of Public Nuisance Prevention of Crime & Disorder	3E

Nishma Parmar, Aarti Babber, Suman Bhadresa & Kusum Bhadresa	Prevention of Public Nuisance	3F
Akwesi Penemo	Prevention of Public Nuisance Public Safety	3G

6.0 BACKGROUND INFORMATION

6.1 Designated Premises Supervisor

The proposed Designated Premises Supervisor is Charlotte Elizabeth Atkinson, who holds a Personal Licence issued by the London Borough of Hillingdon.

6.2 A map of the area and photos of the premises can be found in **Appendix 4 and 5** respectively.

7.0 OFFICER'S OBSERVATIONS

7.1 This is an application for a new Premises Licence for a Pan Asian restaurant and bar which seeks authorisation for licensable activities from 11:00 – 00:00 hours Sunday to Thursday and from 11:00 – 01:00 hours on Friday and Saturday. The premises is situated in a parade alongside JJ Moons and TEN Restaurant with a number of commercial/retail premises nearby and Ruislip Manor underground station across the road. There is residential accommodation above the premises so the potential for public nuisance is a consideration. The nature of the business is also unclear i.e. is it restaurant or a vertical drinking premises.

7.2 History

Date	Incident	Details	Action
25/07/2022	Member's Enquiry received	Loud music from 20:00 hrs on 23/07 until 06:00 hrs on 24/07/22	26/07/22 licensing officer visited premises but no access. Letter sent on 28/07/22. No response.
22/10/2022	Complaint to noise team	Loud music reported at 22:11 hrs	Officers attended 22:50 hrs. Loud music not witnessed. Called out 45 mins later. Returned to site & witnessed loud music – DJ. Officers spoke to owner & music turned off.
Nov 2022	Responsible Authorities (Police, ASBET & Licensing Authority) requested a meeting at SAKI with Miss Atkinson at 11:00 hrs on 07/12/22		Letter sent to business address & to home address. No response to appointment letters. Rang mobile tel no multiple times – no answer. Attended SAKI on 07/12/22 – Miss Atkinson was not there. Rang mobile – no answer. Rang licensing agent – they could not contact her either. Follow up email sent – no response.
25/11/2022	Late TEN submitted	Private birthday party on 03/12/22 from 18:00 – 00:00. Sale of alcohol, regulated entertainment & late-night refreshment	TEN issued with covering letter advising of noise complaints from the venue.
24/07/2023	Enquiry received about submitting a Late TEN	Party on 29/07/23 until 00:00 hrs	Advised out of time for a Late TEN

26/07/2023	Late TEN submitted	Private party on 05/08/23 18:00 – 00:00. Sale of alcohol, regulated entertainment & late-night refreshment	TEN issued
10/08/2023	Late TEN submitted	Private party on 19/08/23 18:00 – 00:00. Sale of alcohol, regulated entertainment & late-night refreshment	TEN issued
19/08/2023	Complaint to noise team	Loud music	Officers visited site – noise nuisance witnessed. SAKI rear fire exit doors blocked, 2 males appeared to be smoking what smelt like cannabis & intoxicated female seen. 15-20 patrons outside on the street. No doorman. Spoke to owner about noise – music to be turned down. Other matters witnessed were discussed.
19/09/2023	TEN submitted	Private brunch all day party on 30/09/23 11:00 – 00:00. Sale of alcohol, regulated entertainment & late-night refreshment	Objection from Police Licensing. Counter notice served
26/10/2023	Responsible Authority meeting with Miss Atkinson at Ruislip Police station		

7.3 The representations received mainly raise the following issues:

a) The prevention of crime and disorder

Police Licensing have raised concerns about the problems that are already being encountered at the premises e.g. the levels of intoxication of patrons, people allegedly smoking cannabis and the premises causing a statutory noise nuisance with loud music.

The Licensing Authority has raised concerns about nature of the premises as this will have an impact on the proposal to have a minimum of one door supervisor present on a Friday and Saturday night.

An Interested Party raises concerns about the potential increase in problems already being experienced in the area in terms of antisocial behaviour, fighting, underage drinking and drug use.

b) The prevention of public nuisance

The majority of the concerns raised are about the potential for noise nuisance e.g. from music and performances of dance until 01:00 hours and from patrons congregating on the street outside

given that there are residential properties above the premises and the lack of adequate sound proofing.

Incidents that have already occurred at the premises, namely the events of Sunday 24th July 2022 and Saturday 19th August 2023, have been cited. In addition, one resident has included reference numbers for noise nuisance complaints that have already been logged with the Council. These concerns are supported by the Environmental Protection Team. As a result of such experiences, the Interested Parties are not confident that the premises will be operated in a responsible and considerate manner.

The operating hours are also a cause for concern with activities proposed to continue into the early hours of the mornings thus disrupting residents' ability to enjoy their homes and disrupting their ability to sleep. The Licensing Authority has echoed concerns about the proposed finishing times for Regulated Entertainment. This should be given due consideration as although the applicant has detailed in their Operating Schedule the measures they will take to ensure that they do not cause nuisance or disturbance to their neighbours, the later the terminal hour applied for, the greater will be the need to address the issues of disturbance and nuisance.

c) The protection of children from harm

An Interested Party has expressed concerns for the well being of their children should the proposed activities disturb their sleep and affect their schooling.

d) Public Safety

An Interested Party has raised concerns about the fact that machinery had been placed right outside fire exits and stairwells during the refurbishment of the premises. Maintaining an unobstructed means of escape from the premises is also a concern for the Licensing Authority who have requested a condition in relation to this very matter.

Concerns have also been raised about the safety of intoxicated patrons and the knock-on effect for the safety of members of the public.

In relation to comments regarding setting a "dangerous precedent" for other business nearby to apply to extend their licences by allowing SAKI to operate later, it should be remembered that each application made under the Licensing Act 2003 must be assessed on its individual merits. The London Borough of Hillingdon also does not have a Cumulative Impact Policy in force, and matters pertaining to perceptions of 'need' are for the market and Planning to consider, not Licensing.

It should also be noted that there is no fixed restriction on terminal hours anywhere in the borough. This is in accordance with the Guidance where the aim is to reduce the potential for concentrations and achieve a slower dispersal of people from licensed premises through flexible opening times. The Council's Licensing Policy also mirrors the Guidance and states that arbitrary restrictions which would undermine the principle of flexibility must be avoided. The four licensing objectives will be always paramount, and each case will be considered on their individual merit.

8.0 RELEVANT SECTIONS OF S.182 GUIDANCE

8.1 Determining actions that are appropriate for the promotion of the licensing objectives

At paragraph 9.42 it states that "Licensing authorities are best placed to determine what actions are appropriate for the promotion of the licensing objectives in their areas. All licensing determinations should be considered on a case-by-case basis. They should take into account any representations or objections that have been received from responsible authorities or other persons, and representations made by the applicant or premises user as the case may be".

At paragraph 9.43 it states that "The authority's determination should be evidence-based, justified as being appropriate for the promotion of the licensing objectives and proportionate to what it is intended to achieve".

At paragraph 9.44 it states that "Determination of whether an action or step is appropriate for the promotion of the licensing objectives requires an assessment of what action or step would be suitable to achieve that end. While this does not therefore require a licensing authority to decide that no lesser step will achieve the aim, the authority should aim to consider the potential burden that the condition would impose on the premises licence holder (such as the financial burden due to restrictions on licensable activities) as well as the potential benefit in terms of the promotion of the licensing objectives.

However, the Revised Guidance issued under section 182 of the Licensing Act 2003 informs that it is imperative that the authority ensures that the factors which form the basis of its determination are limited to consideration of the promotion of the objectives and nothing outside those parameters. As with the consideration of licence variations, the licensing authority should consider wider issues such as other conditions already in place to mitigate potential negative impact on the promotion of the licensing objectives and the track record of the business.

Further advice on determining what is appropriate when imposing conditions on a licence or certificate is provided in Chapter 10. The licensing authority is expected to come to its determination based on an assessment of the evidence on both the risks and benefits either for or against making the determination".

8.2 Proportionality

At paragraph 10.2 it states, "Conditions include any limitations or restrictions attached to a licence or certificate and essentially are the steps or actions that the holder of the premises licence or the club premises certificate will be required to take or refrain from taking in relation to the carrying on of licensable activities at the premises in question.

Failure to comply with any condition attached to a licence or certificate is a criminal offence, which on conviction is punishable by an unlimited fine or up to six months' imprisonment. The courts have made clear that it is particularly important that conditions which are imprecise or difficult for a licence holder to observe should be avoided."

At paragraph 10.8 it states, "The licensing authority may not impose any conditions unless its discretion has been exercised following receipt of relevant representations and it is satisfied as a result of a hearing (unless all parties agree a hearing is not necessary) that it is appropriate to impose conditions to promote one or more of the four licensing objectives.

In order to promote the crime prevention licensing objective conditions may be included that are aimed at preventing illegal working in licensed premises. This provision also applies to minor variations."

At paragraph 10.9 It is possible that in some cases no additional conditions will be appropriate to promote the licensing objectives.

At paragraph 10.10 it states that "The 2003 Act requires that licensing conditions should be tailored to the size, type, location and characteristics and activities taking place at the premises concerned. Conditions should be determined on a case-by-case basis and standardised conditions which ignore these individual aspects should be avoided.

For example, conditions should not be used to implement a general policy in a given area such as the use of CCTV, polycarbonate drinking vessels or identity scanners where they would not be appropriate to the specific premises. Conditions that are considered appropriate for the prevention of illegal working in premises licensed to sell alcohol or late-night refreshment might include requiring a premises licence holder to undertake right to work checks on all staff employed at the licensed premises or requiring that a copy of any document checked as part of a right to work check, either physical or digital (e.g. copy of any document checked or a clear copy of the online right to work check) is retained at the licensed premises. Licensing authorities and other responsible authorities should be alive to the indirect costs that can arise because of conditions.

These could be a deterrent to holding events that are valuable to the community or for the funding of good and important causes. Licensing authorities should therefore ensure that any conditions they impose are only those which are appropriate for the promotion of the licensing objectives".

8.3 Hours of Trading

At paragraph 10.13 it states "The Government acknowledges that different licensing strategies may be appropriate for the promotion of the licensing objectives in different areas. The 2003 Act gives the licensing authority power to make decisions about the hours during which premises can conduct licensable activities as part of the implementation of its licensing policy statement.

Licensing authorities are best placed to make decisions about appropriate opening hours in their areas based on their local knowledge and in consultation with responsible authorities. However, licensing authorities must always consider each application and must not impose predetermined licensed opening hours, without giving individual consideration to the merits of each application".

At paragraph 10.14 it states, "Where there are objections to an application to extend the hours during which licensable activities are to be carried on and the licensing authority determines that this would undermine the licensing objectives, it may reject the application or grant it with appropriate conditions and/or different hours from those requested."

8.4 Licensing Hours

At paragraph 14.51 With regard to licensing hours, the Government acknowledges that different licensing approaches may be appropriate for the promotion of the licensing objectives in different areas. The 2003 Act gives the licensing authority power to make decisions regarding licensed opening hours as part of the implementation of its licensing policy statement and licensing authorities are best placed to make such decisions based on their local knowledge and in consultation with other responsible authorities. However, licensing authorities must always consider each application and must not impose predetermined licensed opening hours, without giving individual consideration to the merits of each application.

At paragraph 14.52 Statements of licensing policy should set out the licensing authority's approach regarding licensed opening hours and the strategy it considers appropriate for the promotion of the licensing objectives in its area.

The statement of licensing policy should emphasise the consideration which will be given to the individual merits of an application. The Government recognises that licensed premises make an important contribution to our local communities and has given councils a range of tools to effectively manage the different pressures that licensed premises can bring. In determining appropriate strategies around licensed opening hours, licensing authorities cannot seek to restrict the activities of licensed premises where it is not appropriate for the promotion of the licensing objectives to do so.

8.5 The Need for Licensed Premises

At paragraph 14.19 There can be confusion about the difference between the "need" for premises and the "cumulative impact" of premises on the licensing objectives, for example, on crime and disorder. "Need" concerns the commercial demand for another pub or restaurant or hotel and is a matter for the planning authority and for the market. This is not a matter for a licensing authority in discharging its licensing functions or for its statement of licensing policy.

9.0 RELEVANT SECTIONS OF HILLINGDON'S LICENSING POLICY

9.1 Licensing Objectives – The Prevention of Crime and Disorder

At paragraph 10.1 Licensed premises, especially those offering late night/early morning entertainment, alcohol and refreshment, can be a source of crime and disorder. The Licensing Authority will expect operating schedules to satisfactorily address these issues from the design of the premises through to the daily operation of the business. Applicants are recommended to seek advice from the Police Licensing Officer and Licensing Authority Officers prior to making any application as early advice can alleviate representations being made once an application is submitted. Full contact details for both are contained within the Responsible Authorities contact in appendix B.

At paragraph 10.3 Where a number of premises may be in close proximity it may be difficult to attribute the disorder to patrons of particular premises, however there is a duty on Premises Licence Holders or Club Management Committees to act responsibly to ensure their own customers do not contribute to crime and disorder whilst in their premises and in the vicinity of their premises.

At paragraph 10.6 Applications referred to the Licensing Sub-Committee where relevant representations have been received will be determined on the individual merit of each case. The Licensing Sub-Committee has the power to impose specific conditions when considered appropriate in respect of the Crime and Disorder objective.

9.2 Licensing Objectives – Public Safety

At paragraph 11.5 Applications referred to the Licensing Sub-Committee will be determined on the individual merit of each case. The Licensing Sub-Committee have the power to impose specific conditions when considered necessary in respect of the Public Safety objective.

9.3 Licensing Objectives – The Prevention of Public Nuisance

At paragraph 12.1 Licensing Sub Committees will be mindful that licensed premises, especially those operating late at night and in the early hours of the morning, can cause a range of nuisances impacting on people living, working or sleeping in the vicinity of the premises. When addressing public nuisance the applicant should identify any particular issues that are likely to affect adversely the promotion of the licensing objective to prevent public nuisance. They should then include in the operating schedule how they will deal with those matters. The concerns mainly relate to noise nuisance from within the premises or from the use of any outside areas, light pollution, smoke and noxious smells. This may also include patrons outside a premises and the dispersal of customers. Due regard will be given to the impact these may have and the Licensing Authority will expect operating schedules to satisfactorily address these issues.

At paragraph 12.7 Applications referred to the Licensing Sub-Committee will be determined on the individual merit of each case. The Licensing Sub-Committee have the power to impose specific conditions when considered necessary in respect of the Prevention of Public Nuisance objective.

9.4 Licensing Objectives – The Protection of Children from Harm

At paragraph 13.7 Applications referred to the Licensing Sub-Committee will be determined on the individual merit of each case. The Licensing Sub-Committee have the power to impose specific conditions when considered necessary in respect of the Protection of Children from Harm objective.

9.5 Representations

At paragraph 17.2 Representations can be made to the Council, as Licensing Authority, by a 'Responsible Authority' or by 'Interested Parties' which include individuals such as residents or bodies such as a resident's association, trade associations and other businesses operating. Representations can be made concerning:

- Applications for new premises licences or club premises certificates
- Applications to vary premises licences or club premises certificates
- Personal licence applications on criminal grounds (only by the Police)

At paragraph 17.9 The Licensing Act 2003 also permits Elected Members to make representations on their own behalf as well as on behalf of their constituents. Members of the public who are making representations may also request that their Ward Councillor speaks on their behalf at public hearings to determine applications.

At paragraph 17.11 Written representations include letters and emails. Representations received after the end of the public consultation period cannot legally be accepted and will not be considered by the Licensing Authority.

At paragraph 17.12 Representations must contain;

- a) The name, full address & post code, of the person making them;
- b) The reasons for their representation;

c) Which of the four Licensing Objectives the representation relates to i.e. Crime and disorder; Public Nuisance; Public safety; Protection of children from harm.

At paragraph 17.14 Representations based on 'Need' for licensed premises, concerns the commercial demand for another pub, restaurant, off licence or hotel. This is not a matter for the licensing authority in discharging its licensing functions. 'Need' is a matter for planning committees and for the market. Representations made on the basis of need are likely to be rejected.

At paragraph 17.15 All valid representations will form part of a committee report that will become a public document. It will be given to the applicant, their agent, responsible authorities, other persons making representations and any other party requesting a copy as well as the Licensing Sub-committee 10 working days prior to the hearing. Anonymous representations will not be accepted.

9.6 Licensing Hours

At paragraph 25.1 Prior to the introduction of the Licensing Act 2003, it was believed that fixed and artificially early closing times (established under the Licensing Act 1964) were one of the key causes of rapid binge drinking prior to closing times and one of the causes of disorder and disturbance when large number of customers were required to leave the premises simultaneously.

At paragraph 25.2 The aim through promotion of the licensing objectives should be to reduce the potential for concentrations and achieve a slower dispersal of people from licensed premises through flexible opening times.

At paragraph 25.3 Arbitrary restrictions that would undermine the principle of flexibility will therefore be avoided. The four licensing objectives will be paramount at all times and the Council will always consider the individual merits of each case.

At paragraph 25.4 In accordance with guidance there is no fixed restriction on terminal hours for any particular areas of the borough. Such a restriction could cause the migration of patrons from one area to another and create the circumstances that the legislation is attempting to avoid. Each application will be dealt with on its merits. It is for the applicants to detail in their Operating Schedule exactly what times they intend to open and close the premises and what measures they will take to ensure that they do not cause nuisance or disturbance to their neighbours in the vicinity. The later the terminal hour applied for, the greater will be the need to address the issues of disturbance and nuisance.

9.7 Licence Conditions

At paragraph 20.1 Conditions on premises licences and club certificates are determined by:

- The measures put forward on the Operating Schedule
- Mandatory conditions within the Act (current list included as Appendix G)
- Measures decided at a hearing by the Licensing Sub Committee

At paragraph 20.2 Conditions attached to licences by the Licensing Authority that have been proposed by the applicant in their operating schedule should be consistent with the steps set out in the operating schedule. This means that the effect of these conditions should be substantially the same as that intended by the terms of the operating schedule.

At paragraph 20.3 Any conditions attached to licences following relevant representations will focus on matters within the control of the Premises Licence Holder or Club Management Committees. They will address matters which have a direct impact on those living, working or engaged in normal activities in the vicinity, as well as patrons of the licensed premises.

They will not be used as a means of attempting to attach responsibility to Premises Licence Holders or Club Management Committees for matters outside their reasonable control, such as anti-social behaviour once away from the premises or licensable activity. Conditions imposed by the Licensing Authority shall be appropriate, reasonable, and proportionate and should be determined on a case-by-case basis.

At paragraph 20.4 The Licensing Authority will not impose standard conditions upon every licence issued, however it may have regard to model conditions produced by the Government and/or the Institute of Licensing and it may choose to impose these in appropriate circumstances.

10.0 LEGAL CONSIDERATIONS

- 10.1 When considering an application for a grant of a new Premises Licence, the Sub-Committee shall carry out its functions with a view to taking steps it considers appropriate for promoting the licensing objectives. The licensing objectives are:
- Prevention of crime and disorder
 - Public Safety
 - Prevention of public nuisance
 - Protection of children from harm
- 10.2 Members should note that each objective is of equal importance. There are no other licencing objectives, and the four objectives are paramount considerations at all times.
- 10.3 An application for a new premises licence may be made pursuant to s.16 and s.17 of the Act, and with regard to the Licensing Act 2003 (Premises licences and club premises certificates) Regulations 2005/42 and the licensing Act 2003 (Fees) Regulations 2005/79.
- 10.4 The Sub-Committee must ensure that all licensing decisions:
- Have a direct relationship to the promotion of one or more of the four licensing objectives
 - Have regard to the Council's statement of licensing policy
 - Have regard to the Secretary of State guidance
 - Must not be subject to a blanket policy to the extent that it is applied so rigidly that an exercise of discretion in each individual case is precluded
- 10.5 Where relevant representations are made, the Licensing Authority must hold a hearing to determine the application, unless all are agreed that such a hearing is unnecessary s.18(3)(a) Licensing Act 2003.
- 10.6 Relevant representations are those that relate to the effect of the granting of the application on the promotion of the licensing objectives made by an interested party or responsible authority that have not been withdrawn and are not, in the opinion of the relevant licencing authority, frivolous or vexatious s.18(7) Licensing Act 2003.
- 10.7 The Sub-Committee can only consider matters within the application that have been raised through representations from interested parties and responsible authorities. Interested parties must live within the vicinity of the premises. All applications will be decided on a case-by-case basis.
- 10.8 Following a hearing, the Sub-Committee must consider all relevant representations, and having taken into account the promotion of the licensing objectives, under s.18(3)(b) and (4) Licensing Act 2003, a decision can be taken: -
- i. To grant the licence, subject to the mandatory conditions and conditions consistent with the operating schedule;
 - ii. To impose additional relevant conditions to such an extent as is considered necessary for the promotion of the licensing objectives;
 - iii. To exclude any of the licensable activities to which the application relates;
 - iv. To amend the times for all or some of the licensable activities;
 - v. To refuse to specify a person in the licence as the premises supervisor;
 - vi. To reject the application.
- 10.9 Conditions will not be necessary if they duplicate a current statutory requirement. The licencing Authority may therefore only impose such conditions that are necessary to promote the licensing objectives arising out of the consideration of the representations.

- 10.10 If the Sub-Committee determines that it is necessary to modify the conditions, or to refuse the application for a Premises Licence application, it must give reasons for its decision.
- 10.11 The Council in its capacity as Licensing Authority has a duty to have regard to its public sector equality duty under s.149 of the Equality Act 2010. In summary s.149 provides that a Public Authority must, in the exercise of its functions, have due regard to the need to:
- i. Eliminate discrimination harassment, victimisation and any other conduct that is prohibited by or under this Act;
 - ii. Advance equality of opportunity between persons who share a relevant protected characteristic and persons who do not share it; and
 - iii. Foster good relations between persons who share relevant protected characteristics and persons who do not.
- 10.12 Section 149(7) of the Equality Act 2010 defines nine relevant protected characteristics these are:
- i. age
 - ii. gender reassignment
 - iii. being married or in a civil partnership
 - iv. being pregnant or on maternity leave
 - v. disability
 - vi. race including colour, nationality, ethnic or national origin
 - vii. religion or belief
 - viii. sex
 - ix. sexual orientation
- 10.13 Officers have provided the Sub-Committee with recommendations related to this application. Subject to the above-mentioned factors having been properly considered, the Sub-Committee may depart from the recommendations if there are good reasons for doing so. The Sub-Committee is advised that such departures could give rise to an appeal or judicial review.
- 10.14 Interested parties, Responsible Authorities and the Applicant have the right to appeal the decision of the Licensing Sub-Committee to the Magistrates' Court within a period of 21 days beginning with the day on which the applicant was notified by the Licensing Authority of the decision to be appealed against.



Hillingdon
Application for a premises licence
Licensing Act 2003

For help contact
licensing@hillington.gov.uk
 Telephone: 01895 558170

* required information

Section 1 of 21

You can save the form at any time and resume it later. You do not need to be logged in when you resume.

System reference

Not Currently In Use

This is the unique reference for this application generated by the system.

Your reference

You can put what you want here to help you track applications if you make lots of them. It is passed to the authority.

Are you an agent acting on behalf of the applicant?

Yes No

Put "no" if you are applying on your own behalf or on behalf of a business you own or work for.

Applicant Details

* First name

Charlotte Elizabeth

* Family name

Atkinson

* E-mail

Main telephone number

Include country code.

Other telephone number

Indicate here if the applicant would prefer not to be contacted by telephone

Is the applicant:

- Applying as a business or organisation, including as a sole trader
 Applying as an individual

A sole trader is a business owned by one person without any special legal structure. Applying as an individual means the applicant is applying so the applicant can be employed, or for some other personal reason, such as following a hobby.

Continued from previous page...

Address

* Building number or name	<input type="text" value="141B"/>
* Street	<input type="text" value="Swakeleys Road"/>
District	<input type="text"/>
* City or town	<input type="text" value="Ickenham"/>
County or administrative area	<input type="text"/>
* Postcode	<input type="text" value="UB10 8DL"/>
* Country	<input type="text" value="United Kingdom"/>

Agent Details

* First name	<input type="text" value="Manpreet Singh"/>
* Family name	<input type="text" value="Kapoor"/>
* E-mail	<input type="text" value="info@personalllicencecourses.com"/>
Main telephone number	<input type="text" value="020 8606 0558"/>
Other telephone number	<input type="text"/>

Include country code.

Indicate here if you would prefer not to be contacted by telephone

Are you:

- An agent that is a business or organisation, including a sole trader
- A private individual acting as an agent

A sole trader is a business owned by one person without any special legal structure.

Your Address

Address official correspondence should be sent to.

* Building number or name	<input type="text" value="Personal Licence Courses UK"/>
* Street	<input type="text" value="145 Station Road"/>
District	<input type="text"/>
* City or town	<input type="text" value="West Drayton"/>
County or administrative area	<input type="text"/>
* Postcode	<input type="text" value="UB7 7ND"/>
* Country	<input type="text" value="United Kingdom"/>

Section 2 of 21

PREMISES DETAILS

Continued from previous page...

I/we, as named in section 1, apply for a premises licence under section 17 of the Licensing Act 2003 for the premises described in section 2 below (the premises) and I/we are making this application to you as the relevant licensing authority in accordance with section 12 of the Licensing Act 2003.

Premises Address

Are you able to provide a postal address, OS map reference or description of the premises?

- Address OS map reference Description

Postal Address Of Premises

Building number or name	<input type="text" value="Saki"/>
Street	<input type="text" value="Unit 2, 8 Victoria Road"/>
District	<input type="text"/>
City or town	<input type="text" value="Ruilsip"/>
County or administrative area	<input type="text"/>
Postcode	<input type="text" value="HA4 0AA"/>
Country	<input type="text" value="United Kingdom"/>

Further Details

Telephone number	<input type="text"/>
Non-domestic rateable value of premises (£)	<input type="text" value="7,100"/>

Section 3 of 21

APPLICATION DETAILS

In what capacity are you applying for the premises licence?

- An individual or individuals
- A limited company / limited liability partnership
- A partnership (other than limited liability)
- An unincorporated association
- Other (for example a statutory corporation)
- A recognised club
- A charity
- The proprietor of an educational establishment
- A health service body
- A person who is registered under part 2 of the Care Standards Act 2000 (c14) in respect of an independent hospital in Wales
- A person who is registered under Chapter 2 of Part 1 of the Health and Social Care Act 2008 in respect of the carrying on of a regulated activity (within the meaning of that Part) in an independent hospital in England
- The chief officer of police of a police force in England and Wales

Confirm The Following

- I am carrying on or proposing to carry on a business which involves the use of the premises for licensable activities
- I am making the application pursuant to a statutory function
- I am making the application pursuant to a function discharged by virtue of Her Majesty's prerogative

Section 4 of 21

INDIVIDUAL APPLICANT DETAILS

Applicant Name

Is the name the same as (or similar to) the details given in section one?

- Yes No

If "Yes" is selected you can re-use the details from section one, or amend them as required. Select "No" to enter a completely new set of details.

First name

Family name

Is the applicant 18 years of age or older?

- Yes No

Continued from previous page...

Current Residential Address

Is the address the same as (or similar to) the address given in section one?

If "Yes" is selected you can re-use the details from section one, or amend them as required. Select "No" to enter a completely new set of details.

Yes No

Building number or name	<input type="text" value="141B"/>
Street	<input type="text" value="Swakeleys Road"/>
District	<input type="text"/>
City or town	<input type="text" value="Ickenham"/>
County or administrative area	<input type="text"/>
Postcode	<input type="text" value="UB10 8DL"/>
Country	<input type="text" value="United Kingdom"/>

Applicant Contact Details

Are the contact details the same as (or similar to) those given in section one?

If "Yes" is selected you can re-use the details from section one, or amend them as required. Select "No" to enter a completely new set of details.

Yes No

E-mail	<input type="text"/>
Telephone number	<input type="text"/>
Other telephone number	<input type="text"/>
* Date of birth	<input type="text"/> / <input type="text"/> / <input type="text"/> dd mm yyyy
* Nationality	<input type="text" value="BRITISH"/>
Right to work share code	<input type="text"/>

[Documents that demonstrate entitlement to work in the UK](#)
[Right to work share code if not submitting scanned documents](#)

Section 5 of 21

OPERATING SCHEDULE

When do you want the premises licence to start? / /
dd mm yyyy

If you wish the licence to be valid only for a limited period, when do you want it to end / /
dd mm yyyy

Provide a general description of the premises

Continued from previous page...

For example the type of premises, its general situation and layout and any other information which could be relevant to the licensing objectives. Where your application includes off-supplies of alcohol and you intend to provide a place for consumption of these off-supplies you must include a description of where the place will be and its proximity to the premises.

Pan Asian Restaurant and Bar

If 5,000 or more people are expected to attend the premises at any one time, state the number expected to attend

Section 6 of 21

PROVISION OF PLAYS

[See guidance on regulated entertainment](#)

Will you be providing plays?

- Yes No

Section 7 of 21

PROVISION OF FILMS

[See guidance on regulated entertainment](#)

Will you be providing films?

- Yes No

Section 8 of 21

PROVISION OF INDOOR SPORTING EVENTS

[See guidance on regulated entertainment](#)

Will you be providing indoor sporting events?

- Yes No

Section 9 of 21

PROVISION OF BOXING OR WRESTLING ENTERTAINMENTS

[See guidance on regulated entertainment](#)

Will you be providing boxing or wrestling entertainments?

- Yes No

Section 10 of 21

PROVISION OF LIVE MUSIC

[See guidance on regulated entertainment](#)

Will you be providing live music?

- Yes No

Standard Days And Timings

Continued from previous page...

MONDAY

Start

End

Start

End

Give timings in 24 hour clock.
(e.g., 16:00) and only give details for the days
of the week when you intend the premises
to be used for the activity.

TUESDAY

Start

End

Start

End

WEDNESDAY

Start

End

Start

End

THURSDAY

Start

End

Start

End

FRIDAY

Start

End

Start

End

SATURDAY

Start

End

Start

End

SUNDAY

Start

End

Start

End

Will the performance of live music take place indoors or outdoors or both?

- Indoors Outdoors Both

Where taking place in a building or other
structure tick as appropriate. Indoors may
include a tent.

State type of activity to be authorised, if not already stated, and give relevant further details, for example (but not exclusively) whether or not music will be amplified or unamplified.

None

State any seasonal variations for the performance of live music

For example (but not exclusively) where the activity will occur on additional days during the summer months.

None

Continued from previous page...

Non-standard timings. Where the premises will be used for the performance of live music at different times from those listed in the column on the left, list below

For example (but not exclusively), where you wish the activity to go on longer on a particular day e.g. Christmas Eve.

None

Section 11 of 21

PROVISION OF RECORDED MUSIC

[See guidance on regulated entertainment](#)

Will you be providing recorded music?

Yes No

Standard Days And Timings

MONDAY

Start

End

Start

End

Give timings in 24 hour clock.
(e.g., 16:00) and only give details for the days
of the week when you intend the premises
to be used for the activity.

TUESDAY

Start

End

Start

End

WEDNESDAY

Start

End

Start

End

THURSDAY

Start

End

Start

End

FRIDAY

Start

End

Start

End

SATURDAY

Start

End

Start

End

Continued from previous page...

SUNDAY

Start End

Start End

Will the playing of recorded music take place indoors or outdoors or both?

Indoors Outdoors Both

Where taking place in a building or other structure tick as appropriate. Indoors may include a tent.

State type of activity to be authorised, if not already stated, and give relevant further details, for example (but not exclusively) whether or not music will be amplified or unamplified.

None

State any seasonal variations for playing recorded music

For example (but not exclusively) where the activity will occur on additional days during the summer months.

None

Non-standard timings. Where the premises will be used for the playing of recorded music at different times from those listed in the column on the left, list below

For example (but not exclusively), where you wish the activity to go on longer on a particular day e.g. Christmas Eve.

None

Section 12 of 21

PROVISION OF PERFORMANCES OF DANCE

[See guidance on regulated entertainment](#)

Will you be providing performances of dance?

Yes No

Standard Days And Timings

MONDAY

Start End

Start End

Give timings in 24 hour clock. (e.g., 16:00) and only give details for the days of the week when you intend the premises to be used for the activity.

TUESDAY

Start End

Start End

Continued from previous page...

WEDNESDAY

Start	<input type="text" value="11:00"/>	End	<input type="text" value="00:00"/>
Start	<input type="text"/>	End	<input type="text"/>

THURSDAY

Start	<input type="text" value="11:00"/>	End	<input type="text" value="00:00"/>
Start	<input type="text"/>	End	<input type="text"/>

FRIDAY

Start	<input type="text" value="11:00"/>	End	<input type="text" value="01:00"/>
Start	<input type="text"/>	End	<input type="text"/>

SATURDAY

Start	<input type="text" value="11:00"/>	End	<input type="text" value="01:00"/>
Start	<input type="text"/>	End	<input type="text"/>

SUNDAY

Start	<input type="text" value="11:00"/>	End	<input type="text" value="00:00"/>
Start	<input type="text"/>	End	<input type="text"/>

Will the performance of dance take place indoors or outdoors or both?

Where taking place in a building or other structure tick as appropriate. Indoors may include a tent.

- Indoors Outdoors Both

State type of activity to be authorised, if not already stated, and give relevant further details, for example (but not exclusively) whether or not music will be amplified or unamplified.

State any seasonal variations for the performance of dance

For example (but not exclusively) where the activity will occur on additional days during the summer months.

Non-standard timings. Where the premises will be used for the performance of dance at different times from those listed in the column on the left, list below

For example (but not exclusively), where you wish the activity to go on longer on a particular day e.g. Christmas Eve.

Continued from previous page...

Section 13 of 21

PROVISION OF ANYTHING OF A SIMILAR DESCRIPTION TO LIVE MUSIC, RECORDED MUSIC OR PERFORMANCES OF DANCE

[See guidance on regulated entertainment](#)

Will you be providing anything similar to live music, recorded music or performances of dance?

- Yes No

Section 14 of 21

LATE NIGHT REFRESHMENT

Will you be providing late night refreshment?

- Yes No

Standard Days And Timings

MONDAY

Start

End

Start

End

Give timings in 24 hour clock.
(e.g., 16:00) and only give details for the days
of the week when you intend the premises
to be used for the activity.

TUESDAY

Start

End

Start

End

WEDNESDAY

Start

End

Start

End

THURSDAY

Start

End

Start

End

FRIDAY

Start

End

Start

End

SATURDAY

Start

End

Start

End

SUNDAY

Start

End

Start

End

Continued from previous page...

Will the provision of late night refreshment take place indoors or outdoors or both?

- Indoors Outdoors Both

Where taking place in a building or other structure tick as appropriate. Indoors may include a tent.

State type of activity to be authorised, if not already stated, and give relevant further details, for example (but not exclusively) whether or not music will be amplified or unamplified.

NONE

State any seasonal variations

For example (but not exclusively) where the activity will occur on additional days during the summer months.

NONE

Non-standard timings. Where the premises will be used for the supply of late night refreshments at different times from those listed in the column on the left, list below

For example (but not exclusively), where you wish the activity to go on longer on a particular day e.g. Christmas Eve.

NONE

Section 15 of 21

SUPPLY OF ALCOHOL

Will you be selling or supplying alcohol?

- Yes No

Standard Days And Timings

MONDAY

Start

End

Start

End

Give timings in 24 hour clock. (e.g., 16:00) and only give details for the days of the week when you intend the premises to be used for the activity.

TUESDAY

Start

End

Start

End

Continued from previous page...

WEDNESDAY

Start	<input type="text" value="11:00"/>	End	<input type="text" value="00:00"/>
Start	<input type="text"/>	End	<input type="text"/>

THURSDAY

Start	<input type="text" value="11:00"/>	End	<input type="text" value="00:00"/>
Start	<input type="text"/>	End	<input type="text"/>

FRIDAY

Start	<input type="text" value="11:00"/>	End	<input type="text" value="01:00"/>
Start	<input type="text"/>	End	<input type="text"/>

SATURDAY

Start	<input type="text" value="11:00"/>	End	<input type="text" value="01:00"/>
Start	<input type="text"/>	End	<input type="text"/>

SUNDAY

Start	<input type="text" value="11:00"/>	End	<input type="text" value="00:00"/>
Start	<input type="text"/>	End	<input type="text"/>

Will the sale of alcohol be for consumption:

- On the premises Off the premises Both

If the sale of alcohol is for consumption on the premises select on, if the sale of alcohol is for consumption away from the premises select off. If the sale of alcohol is for consumption on the premises and away from the premises select both.

State any seasonal variations

For example (but not exclusively) where the activity will occur on additional days during the summer months.

NONE

Non-standard timings. Where the premises will be used for the supply of alcohol at different times from those listed in the column on the left, list below

For example (but not exclusively), where you wish the activity to go on longer on a particular day e.g. Christmas Eve.

NONE

State the name and details of the individual whom you wish to specify on the licence as premises supervisor

Continued from previous page...

Name

First name	<input type="text" value="Charlotte Elizabeth"/>
Family name	<input type="text" value="Atkinson"/>
Date of birth	<input type="text" value=""/> / <input type="text" value=""/> / <input type="text" value=""/> dd mm yyyy

Enter the contact's address

Building number or name	<input type="text" value="141B"/>
Street	<input type="text" value="Swakeleys Road"/>
District	<input type="text"/>
City or town	<input type="text" value="Ickenham"/>
County or administrative area	<input type="text"/>
Postcode	<input type="text" value="UB10 8DL"/>
Country	<input type="text" value="United Kingdom"/>
Personal Licence number (if known)	<input type="text" value="LBHIL 4641"/>
Issuing licensing authority (if known)	<input type="text" value="London Borough of Hillingdon"/>

PROPOSED DESIGNATED PREMISES SUPERVISOR CONSENT

How will the consent form of the proposed designated premises supervisor be supplied to the authority?

- Electronically, by the proposed designated premises supervisor
- As an attachment to this application

Reference number for consent form (if known)

If the consent form is already submitted, ask the proposed designated premises supervisor for its 'system reference' or 'your reference'.

Section 16 of 21

ADULT ENTERTAINMENT

Highlight any adult entertainment or services, activities, or other entertainment or matters ancillary to the use of the premises that may give rise to concern in respect of children

Give information about anything intended to occur at the premises or ancillary to the use of the premises which may give rise to concern in respect of children, regardless of whether you intend children to have access to the premises, for example (but not exclusively) nudity or semi-nudity, films for restricted age groups etc gambling machines etc.

Continued from previous page...

Section 17 of 21

HOURS PREMISES ARE OPEN TO THE PUBLIC

Standard Days And Timings

MONDAY

Start

End

Start

End

Give timings in 24 hour clock.
(e.g., 16:00) and only give details for the days
of the week when you intend the premises
to be used for the activity.

TUESDAY

Start

End

Start

End

WEDNESDAY

Start

End

Start

End

THURSDAY

Start

End

Start

End

FRIDAY

Start

End

Start

End

SATURDAY

Start

End

Start

End

SUNDAY

Start

End

Start

End

State any seasonal variations

For example (but not exclusively) where the activity will occur on additional days during the summer months.

NONE

Non standard timings. Where you intend to use the premises to be open to the members and guests at different times from those listed in the column on the left, list below

For example (but not exclusively), where you wish the activity to go on longer on a particular day e.g. Christmas Eve.

NONE

Continued from previous page...

Section 18 of 21

LICENSING OBJECTIVES

Describe the steps you intend to take to promote the four licensing objectives:

a) General – all four licensing objectives (b,c,d,e)

List here steps you will take to promote all four licensing objectives together.

1. Strict implementation of challenge 25 policy
2. CCTV to be installed and 31 days recoding system
3. All staff to be trained in responsible alcohol retailing
4. Training manual will be available at the premises

b) The prevention of crime and disorder

1. Staff shall be trained in dealing with disorder and staff training records to be kept at the premises available for inspection by the Police and authorised officers of the Council.
2. On Friday and Saturday evenings, there shall be a minimum of 1 door supervisors on duty from 1900 hours until 30 minutes after closing.
3. There shall be a register of all door staff on duty; signed by the door staff, recording their SIA numbers, start and end time of working shift. This register shall be kept at the premises and available for inspection by the Police and authorised officers of the Council.
4. A record shall be kept detailing all refused sales of alcohol. The record should include date and time of the refused sale and the name of the member of staff who refused the sale The record shall be made available to for inspection at the premises by the Police and authorised officers of the Council at all times whilst the premises are open.
5. An Incident Log shall be kept at the premises, and made available on request to an authorised officer of the Council or the Police, which will record the following:
 - a) All crimes reported to the venue;
 - b) Any complaints received regarding crime disorder;
 - c) Any incidents of disorder;
 - d) Any refusal of the sale of alcohol;
 - e) Any visit by a relevant authority or emergency service
6. On Fridays and Saturdays, a Personal Licence holder shall be on the premises from 19.00 hours until the close of premises.
7. The premises shall install and maintain a comprehensive CCTV system covering the premises internally and externally. All entry and entry and exit points will also be covered enabling frontal identification of every person entering. The CCTV system shall continually record whilst the premises are open for licensable activities and during all times when customers remain on the premises. All recordings shall be stored for a minimum of 31 days with date and time stamping. Viewing of recordings shall be made available on request of Police or authorised officers throughout the entire 31 day period.
8. There shall be at least one member of staff on the premises during trading hours who is able to operate the CCTV system so that footage can be viewed and downloaded on request by the Police or authorised officers.
9. No sale of alcohol shall take place when the CCTV system is not fully in good working order.
10. Staff training must be documented and based on legislation and operating procedures. All training shall be signed and dated, and a copy of such records will be available for inspection by Police and local authority enforcement officers.

Continued from previous page...

11. All staff employed at the premises will have UK right to work status checked, once passed that stage they shall be offered employment.

c) Public safety

1. Installation of appropriate safety equipment
2. Fire exit signs displayed
3. CCTV working at all times

d) The prevention of public nuisance

1. Notice displayed asking customers to leave quietly from premises also customers will be told in person to leave quietly and not to disturb the local neighbourhood
2. Appropriate signage will be displayed, in prominent position informing customers they are being recorded on CCTV
3. There shall be no admittance or re-admittance to the premises after (22h00) except for Patrons permitted to temporarily leave the premises to smoke.
4. Patrons permitted to temporarily leave and then re-enter the premises to smoke after 22h00 shall be restricted to a designated smoking area defined as (the front of the premises) and limited to (5) persons at any one time.
5. No noise generated on the premises, or equipment, shall emanate from the premises nor vibration be transmitted through the structure of the premises which gives rise to a nuisance.
6. Notices shall prominently displayed near the entrance and exit doors requesting patrons to respect the needs of local residents and leave the area quietly.
7. A noise limiter shall be in use to ensure that noise from venue do not cause a nuisance to nearby residents.

e) The protection of children from harm

1. A challenge 25 policy will be in force, where any person looking under the age of 25 shall be asked to prove their age when attempting to purchase alcohol and signs to this effect will be displayed at the premises. Challenge 25 posters displayed where alcohol is sold.
2. The only acceptable ID will be those with photographic identification documents, including passport, photo-card, driving license or proof of age card bearing the PASS hologram.
3. An refusal book shall be kept at the premises and updated as and when required, and made available for inspection on request to an Licensing Officer, Police or other responsible authority.
4. The licensee will ensure that staff are trained regularly as appropriate in respect to the Licensing Act 2003 legislation, staff to be trained regularly in underage sales prevention.
5. A sign stating "No proof of age – No sale" shall be displayed at the point of sale.

Section 19 of 21

NOTES ON DEMONSTRATING ENTITLEMENT TO WORK IN THE UK

Continued from previous page...

Entitlement to work/immigration status for individual applicants and applications from partnerships which are not limited liability partnerships:

A licence may not be held by an individual or an individual in a partnership who is resident in the UK who:

- does not have the right to live and work in the UK; or
- is subject to a condition preventing him or her from doing work relating to the carrying on of a licensable activity.

Any premises licence issued in respect of an application made on or after 6 April 2017 will become invalid if the holder ceases to be entitled to work in the UK.

Applicants must demonstrate that they have an entitlement to work in the UK and are not subject to a condition preventing them from doing work relating to the carrying on of a licensable activity. They do this in one of two ways: 1) by providing with this application copies or scanned copies of the documents listed below (which do not need to be certified), or 2) by providing their 'share code' to enable the licensing authority to carry out a check using the Home Office online right to work checking service (see below).

Documents which demonstrate entitlement to work in the UK

- An expired or current passport showing the holder, or a person named in the passport as the child of the holder, is a British citizen or a citizen of the UK and Colonies having the right of abode in the UK [please see note below about which sections of the passport to copy].
- An expired or current passport or national identity card showing the holder, or a person named in the passport as the child of the holder, is a national of a European Economic Area country or Switzerland.
- A Registration Certificate or document certifying permanent residence issued by the Home Office to a national of a European Economic Area country or Switzerland.
- A Permanent Residence Card issued by the Home Office to the family member of a national of a European Economic Area country or Switzerland.
- A **current** Biometric Immigration Document (Biometric Residence Permit) issued by the Home Office to the holder indicating that the person named is allowed to stay indefinitely in the UK, or has no time limit on their stay in the UK.
- A **current** passport endorsed to show that the holder is exempt from immigration control, is allowed to stay indefinitely in the UK, has the right of abode in the UK, or has no time limit on their stay in the UK.
- A **current** Immigration Status Document issued by the Home Office to the holder with an endorsement indicating that the named person is allowed to stay indefinitely in the UK or has no time limit on their stay in the UK, **when produced in combination with** an official document giving the person's permanent National Insurance number and their name issued by a Government agency or a previous employer.
- A birth or adoption certificate issued in the UK, **when produced in combination with** an official document giving the person's permanent National Insurance number and their name issued by a Government agency or a previous employer.
- A birth or adoption certificate issued in the Channel Islands, the Isle of Man or Ireland **when produced in combination with** an official document giving the person's permanent National Insurance number and their name issued by a Government agency or a previous employer.
- A certificate of registration or naturalisation as a British citizen, **when produced in combination with** an official document giving the person's permanent National Insurance number and their name issued by a Government agency or a previous employer.

Continued from previous page...

- A **current** passport endorsed to show that the holder is allowed to stay in the UK and is currently allowed to work and is not subject to a condition preventing the holder from doing work relating to the carrying on of a licensable activity.
- A **current** Biometric Immigration Document (Biometric Residence Permit) issued by the Home Office to the holder which indicates that the named person can currently stay in the UK and is allowed to work relation to the carrying on of a licensable activity.
- A **current** Residence Card issued by the Home Office to a person who is not a national of a European Economic Area state or Switzerland but who is a family member of such a national or who has derivative rights or residence.
- A **current** Immigration Status Document containing a photograph issued by the Home Office to the holder with an endorsement indicating that the named person may stay in the UK, and is allowed to work and is not subject to a condition preventing the holder from doing work relating to the carrying on of a licensable activity **when produced in combination with** an official document giving the person's permanent National Insurance number and their name issued by a Government agency or a previous employer.
- A Certificate of Application, **less than 6 months old**, issued by the Home Office under regulation 18(3) or 20(2) of the Immigration (European Economic Area) Regulations 2016, to a person who is not a national of a European Economic Area state or Switzerland but who is a family member of such a national or who has derivative rights of residence.
- Reasonable evidence that the person has an outstanding application to vary their permission to be in the UK with the Home Office such as the Home Office acknowledgement letter or proof of postage evidence, or reasonable evidence that the person has an appeal or administrative review pending on an immigration decision, such as an appeal or administrative review reference number.
- Reasonable evidence that a person who is not a national of a European Economic Area state or Switzerland but who is a family member of such a national or who has derivative rights of residence in exercising treaty rights in the UK including:-
 - evidence of the applicant's own identity – such as a passport,
 - evidence of their relationship with the European Economic Area family member – e.g. a marriage certificate, civil partnership certificate or birth certificate, and
 - evidence that the European Economic Area national has a right of permanent residence in the UK or is one of the following if they have been in the UK for more than 3 months:
 - (i) working e.g. employment contract, wage slips, letter from the employer,
 - (ii) self-employed e.g. contracts, invoices, or audited accounts with a bank,
 - (iii) studying e.g. letter from the school, college or university and evidence of sufficient funds; or
 - (iv) self-sufficient e.g. bank statements.

Family members of European Economic Area nationals who are studying or financially independent must also provide evidence that the European Economic Area national and any family members hold comprehensive sickness insurance in the UK. This can include a private medical insurance policy, an EHIC card or an S1, S2 or S3 form.

Original documents must not be sent to licensing authorities. If the document copied is a passport, a copy of the following pages should be provided:-

- (i) any page containing the holder's personal details including nationality;
- (ii) any page containing the holder's photograph;
- (iii) any page containing the holder's signature;
- (iv) any page containing the date of expiry; and
- (v) any page containing information indicating the holder has permission to enter or remain in the UK and is permitted to work.

Continued from previous page...

If the document is not a passport, a copy of the whole document should be provided.

Your right to work will be checked as part of your licensing application and this could involve us checking your immigration status with the Home Office. We may otherwise share information with the Home Office. Your licence application will not be determined until you have complied with this guidance.

Home Office online right to work checking service

As an alternative to providing a copy of the documents listed above, applicants may demonstrate their right to work by allowing the licensing authority to carry out a check with the Home Office online right to work checking service.

To demonstrate their right to work via the Home Office online right to work checking service, applicants should include in this application their 9-digit share code (provided to them upon accessing the service at <https://www.gov.uk/prove-right-to-work>) which, along with the applicant's date of birth (provided within this application), will allow the licensing authority to carry out the check.

In order to establish the applicant's right to work, the check will need to indicate that the applicant is allowed to work in the United Kingdom and is not subject to a condition preventing them from doing work relating to the carrying on of a licensable activity.

An online check will not be possible in all circumstances because not all applicants will have an immigration status that can be checked online. The Home Office online right to work checking service sets out what information and/or documentation applicants will need in order to access the service. Applicants who are unable to obtain a share code from the service should submit copy documents as set out above.

Section 20 of 21

NOTES ON REGULATED ENTERTAINMENT

Continued from previous page...

In terms of specific **regulated entertainments** please note that:

- Plays: no licence is required for performances between 08:00 and 23.00 on any day, provided that the audience does not exceed 500.
- Films: no licence is required for 'not-for-profit' film exhibition held in community premises between 08.00 and 23.00 on any day provided that the audience does not exceed 500 and the organiser (a) gets consent to the screening from a person who is responsible for the premises; and (b) ensures that each such screening abides by age classification ratings.
- Indoor sporting events: no licence is required for performances between 08.00 and 23.00 on any day, provided that the audience does not exceed 1000.
- Boxing or Wrestling Entertainment: no licence is required for a contest, exhibition or display of Greco-Roman wrestling, or freestyle wrestling between 08.00 and 23.00 on any day, provided that the audience does not exceed 1000. Combined fighting sports – defined as a contest, exhibition or display which combines boxing or wrestling with one or more martial arts – are licensable as a boxing or wrestling entertainment rather than an indoor sporting event.
- Live music: no licence permission is required for:
 - o a performance of unamplified live music between 08.00 and 23.00 on any day, on any premises.
 - o a performance of amplified live music between 08.00 and 23.00 on any day on premises authorised to sell alcohol for consumption on those premises, provided that the audience does not exceed 500.
 - o a performance of amplified live music between 08.00 and 23.00 on any day, in a workplace that is not licensed to sell alcohol on those premises, provided that the audience does not exceed 500.
 - o a performance of amplified live music between 08.00 and 23.00 on any day, in a church hall, village hall, community hall, or other similar community premises, that is not licensed by a premises licence to sell alcohol, provided that (a) the audience does not exceed 500, and (b) the organiser gets consent for the performance from a person who is responsible for the premises.
 - o a performance of amplified live music between 08.00 and 23.00 on any day, at the non-residential premises of (i) a local authority, or (ii) a school, or (iii) a hospital, provided that (a) the audience does not exceed 500, and (b) the organiser gets consent for the performance on the relevant premises from: (i) the local authority concerned, or (ii) the school or (iii) the health care provider for the hospital.
- Recorded Music: no licence permission is required for:
 - o any playing of recorded music between 08.00 and 23.00 on any day on premises authorised to sell alcohol for consumption on those premises, provided that the audience does not exceed 500.
 - o any playing of recorded music between 08.00 and 23.00 on any day, in a church hall, village hall, community hall, or other similar community premises, that is not licensed by a premises licence to sell alcohol, provided that (a) the audience does not exceed 500, and (b) the organiser gets consent for the performance from a person who is responsible for the premises.
 - o any playing of recorded music between 08.00 and 23.00 on any day, at the non-residential premises of (i) a local authority, or (ii) a school, or (iii) a hospital, provided that (a) the audience does not exceed 500, and (b) the organiser gets consent for the performance on the relevant premises from: (i) the local authority concerned, or (ii) the school proprietor or (iii) the health care provider for the hospital.

Continued from previous page...

- Dance: no licence is required for performances between 08.00 and 23.00 on any day, provided that the audience does not exceed 500. However, a performance which amounts to adult entertainment remains licensable.
- Cross activity exemptions: no licence is required between 08.00 and 23.00 on any day, with no limit on audience size for:
 - o any entertainment taking place on the premises of the local authority where the entertainment is provided by or on behalf of the local authority;
 - o any entertainment taking place on the hospital premises of the health care provider where the entertainment is provided by or on behalf of the health care provider;
 - o any entertainment taking place on the premises of the school where the entertainment is provided by or on behalf of the school proprietor; and
 - o any entertainment (excluding films and a boxing or wrestling entertainment) taking place at a travelling circus, provided that (a) it takes place within a moveable structure that accommodates the audience, and (b) that the travelling circus has not been located on the same site for more than 28 consecutive days.

Section 21 of 21

PAYMENT DETAILS

This fee must be paid to the authority. If you complete the application online, you must pay it by debit or credit card. Premises' licence fees are determined by the non-domestic rateable value of the premises. To find out a premises' non-domestic rateable value, go to the Valuation Office Agency website at http://www.voa.gov.uk/business_rates/index.htm. For full details, refer to the 'Fees for Applications' webpage: <http://www.hillingdon.gov.uk/media.jsp?mediaid=22879&filetype=pdf>

* Fee amount (£)

DECLARATION

* I/we understand it is an offence, liable on conviction to a fine up to level 5 on the standard scale, under section 158 of the licensing act 2003, to make a false statement in or in connection with this application.

Ticking this box indicates you have read and understood the above declaration

This section should be completed by the applicant, unless you answered "Yes" to the question "Are you an agent acting on behalf of the applicant?"

* Full name

* Capacity

* Date / /
dd mm yyyy

Once you're finished you need to do the following:
1. Save this form to your computer by clicking file/save as...
2. Go back to <https://www.gov.uk/apply-for-a-licence/premises-licence/hillingdon/apply-1> to upload this file and continue with your application.
Don't forget to make sure you have all your supporting documentation to hand.

Continued from previous page...

IT IS AN OFFENCE LIABLE TO SUMMARY CONVICTION TO A FINE OF ANY AMOUNT UNDER SECTION 158 OF THE LICENSING ACT 2003, TO MAKE A FALSE STATEMENT IN OR IN CONNECTION WITH THIS APPLICATION

IT IS AN OFFENCE UNDER SECTION 24B OF THE IMMIGRATION ACT 1971 FOR A PERSON TO WORK WHEN THEY KNOW, OR HAVE REASONABLE CAUSE TO BELIEVE, THAT THEY ARE DISQUALIFIED FROM DOING SO BY REASON OF THEIR IMMIGRATION STATUS. THOSE WHO EMPLOY AN ADULT WITHOUT LEAVE OR WHO IS SUBJECT TO CONDITIONS AS TO EMPLOYMENT WILL BE LIABLE TO A CIVIL PENALTY UNDER SECTION 15 OF THE IMMIGRATION, ASYLUM AND NATIONALITY ACT 2006 AND PURSUANT TO SECTION 21 OF THE SAME ACT, WILL BE COMMITTING AN OFFENCE WHERE THEY DO SO IN THE KNOWLEDGE, OR WITH REASONABLE CAUSE TO BELIEVE, THAT THE EMPLOYEE IS DISQUALIFIED

OFFICE USE ONLY

Applicant reference number	<input type="text"/>
Fee paid	<input type="text"/>
Payment provider reference	<input type="text"/>
ELMS Payment Reference	<input type="text"/>
Payment status	<input type="text"/>
Payment authorisation code	<input type="text"/>
Payment authorisation date	<input type="text"/>
Date and time submitted	<input type="text"/>
Approval deadline	<input type="text"/>
Error message	<input type="text"/>
Is Digitally signed	<input type="checkbox"/>

[1](#) [2](#) [3](#) [4](#) [5](#) [6](#) [7](#) [8](#) [9](#) [10](#) [11](#) [12](#) [13](#) [14](#) [15](#) [16](#) [17](#) [18](#) [19](#) [20](#) [21](#) [Next >](#)

PROPOSED LICENCE PLAN

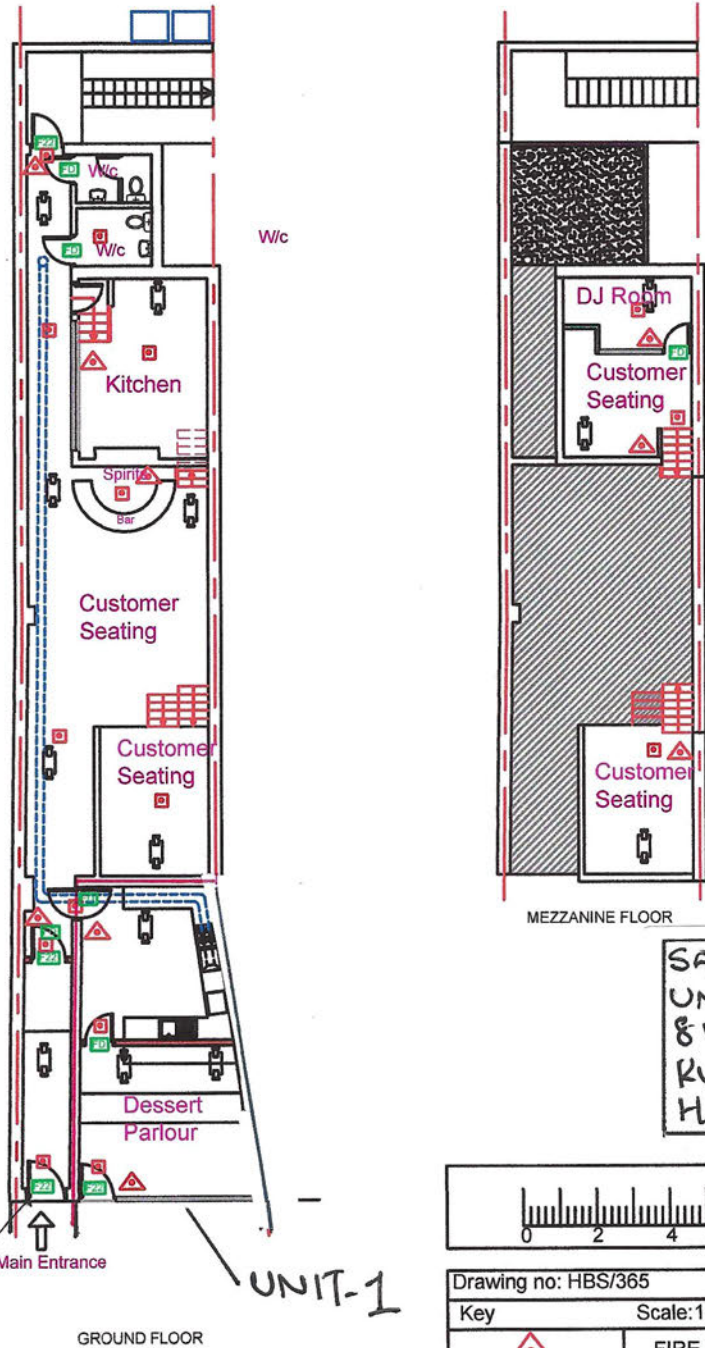

SAKI.
UNIT 2,
8 VICTORIA ROAD
KUISLIP
HAY OAA

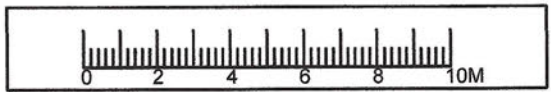

Drawing no: HBS/365		Date: 26th Sept 2023
Key		Scale: 1:200 Paper: A4
△	FIRE EXTINGUISHER	
F22	FIRE EXIT SIGNS	
□	EMERGENCY LIGHTING	
FD	Fire Check Door	
CCTV	CCTV CAMERAS	
CCTV RECORDING 31 DAYS		
SHUTTERS PROVIDED		
ALARM SYSTEM TO AOISPEC OR SIMILAR FITTED		

From: Penelope.Brown@met.police.uk on behalf of Licensing-XH@met.police.uk
Sent: 31 October 2023 14:07
To: licensing@hillingdon.gov.uk
Subject: RE: New Premises Licence application - Saki, Ruislip Manor

Dear Licensing,

The Police Licensing Team wish to submit an objection regarding the new premises licence application at Saki, Unit 2, 8 Victoria Road, Ruislip, HA4 0AA.

The reasons for this relate to problems that have already been encountered at the venue and with the applicant.

Below is a brief summary of our most recent dealings with Miss Atkinson and this venue:

- On 19/08/2023 there was a Temporary Event at the venue between 18:00 and 00:00 hours that was managed by the applicant, Miss Charlotte Atkinson. We were made aware that at this event there were issues including the levels of intoxication of patrons with vomit seen, people smoking cannabis and loud music causing a disturbance which was a statutory noise nuisance.
- On 26/09/2023 Police Licensing held a meeting with Miss Atkinson to discuss the concerns from the event and plans for the premises. During this meeting Miss Atkinson was asked if she was a personal licence holder and she said that she had done some training and a course and thought she probably was, but she was not sure. Her uncertainty did not instil confidence. She is a personal licence holder.

- [REDACTED]

[REDACTED] he also did not inform the Local Authority of the change of address for her personal licence. I called her mobile three times and emailed twice to ask about this. On the fourth call I got a response where Miss Atkinson told me she had done the licensing course around a year ago and didn't know about her obligations.

It is my opinion that Miss Atkinson has a lack of experience and knowledge around managing a licensed premises and does not understand the magnitude of the responsibility in doing so. I do not have any confidence that she will be able to successfully uphold the licensing objectives if this premises licence was granted. The issues from the last event, as described, support this belief.

Further details from relevant police reports can and will be provided should a hearing be scheduled for this application.

Kind regards,
Penny

Penny Brown PC 3267WA
West Area Police Licensing Officer, Hillingdon (XH)
Metropolitan Police Service, West Area.

Ruislip Police Station, The Oaks, Ruislip, Middlesex, HA4 7LE.

w: www.met.police.uk

e: Penelope.Brown@met.pnn.police.uk

e: Licensing-XH@met.pnn.police.uk

From: licensing <licensing@hillingdon.gov.uk>

Sent: 04 October 2023 15:35

To: ASB Investigations <asbinvestigations@hillingdon.gov.uk>; Agnes Forster <AForster@hillingdon.gov.uk>; Amanda Gibbons <agibbons@hillingdon.gov.uk>; Christine Khacherian <CKhacherian@hillingdon.gov.uk>; Navida Khanum <nkhanum@hillingdon.gov.uk>; EPTeam <EPTeam@Hillingdon.gov.uk>; food healthandsafety <foodhealthandsafety@hillingdon.gov.uk>; formsadmin.london@hse.gov.uk; FSR-AdminSupport@london-fire.gov.uk; ISD Alcohol Licensing <alcohol@homeoffice.gov.uk>; licensing <licensing@hillingdon.gov.uk>; Licensing - XH <Licensing-XH@met.police.uk>; Lois King <LKing@hillingdon.gov.uk>; Planning <planning@hillingdon.gov.uk>; Safeguarding children Admin <safeguardingchildrenadmin@hillingdon.gov.uk>; Shikha Sharma <SSharma4@hillingdon.gov.uk>; Trading Standards <tradingstandards@hillingdon.gov.uk>

Subject: New Premises Licence application - Saki, Ruislip Manor

Dear Responsible Authorities

LICENSING ACT 2003

As consultees to the licensing process, please be advised that this department has received an application for a new premises licence for the following premises:

Saki
8 Victoria Road
Ruislip Manor
HA4 0AA

The application and supporting documents are attached for your review.

The consultation period will end on 1st November 2023 and any relevant representations to this application must be received by this date. We are unable to accept any representations received after this date or any representations that are not relevant.

Relevant representations need to relate to the one or more of the four licensing objectives, which are:

- Crime and disorder
- Prevention of children from harm
- Public safety
- Prevention of public nuisance.

Please contact the Licensing Service for further information on 01895 277433 or licensing@hillingdon.gov.uk

Regards

Kerry

Licensing Service
London Borough of Hillingdon
3S/08 Civic Centre
High Street
Uxbridge UB8 1UW
tel: internal: 7433
tel: external: 01895 277433

Hillingdon Council routinely monitors the content of emails sent and received via its network for the purposes of ensuring compliance with its policies and procedures. The contents of this message are for the attention and use of the intended addressee only. If you are not the intended recipient or addressee, or the person responsible for sending the message you may not copy, forward, disclose or otherwise use it or any part of it in any way. To do so may be unlawful. If you receive this email by mistake please advise the sender immediately. Where opinions are expressed they are not necessarily those of the London Borough of Hillingdon. Service by email is not accepted unless by prior agreement.

NOTICE - This email and any attachments are solely for the intended recipient and may be confidential. If you have received this email in error, please notify the sender and delete it from your system. Do not use, copy or disclose the information contained in this email or in any attachment without the permission of the sender. Metropolitan Police Service (MPS) communication systems are monitored to the extent permitted by law and any email and/or attachments may be read by monitoring staff. Only specified personnel are authorised to conclude binding agreements on behalf of the MPS by email and no responsibility is accepted for unauthorised agreements reached with other personnel. While reasonable precautions have been taken to ensure no viruses are present in this email, its security and that of any attachments cannot be guaranteed.



HILLINGDON
LONDON

Mrs Lois King
Licensing Officer
The Licensing Service
London Borough of Hillingdon
Civic Centre
High Street
Uxbridge
UB8 1UW

Date: 27th October 2023

Dear Mrs King,

LICENSING ACT 2003
SAKI, UNIT 2, 8 VICTORIA ROAD, RUISLIP HA4 0AA

I am writing to you as the Officer duly authorised to make representations on behalf of the Licensing Authority, in relation to the application for a new premises licence submitted by Miss Charlotte Atkinson.

The application proposes for the sale of alcohol 11:00 to 00:00 hours Sunday to Thursday and 11:00 to 01:00 hours Friday and Saturday. Miss Atkinson has also applied for regulated entertainment in the form of the performance of dance, live music and recorded music for the same times. Furthermore, Miss Atkinson proposes to provide late night refreshment from 23:00 to 00:00 hours Sunday to Thursday and 23:00 to 01:00 hours Friday and Saturday.

The Licensing Authority wishes to make a representation against this application based on the following licensing objectives:

The prevention of crime and disorder
The prevention of public nuisance
Public safety

Firstly, at Section 5 of the application, the applicant describes the premises as a "Pan Asian Restaurant and Bar". Looking at their full operating schedule and the plans, it is unclear as to whether the premises will be a restaurant or predominantly a vertical drinking premises. It appears that it is proposed to be a combination of both. The plans make reference to "Customer Seating" and a "Kitchen". Therefore, the Licensing Authority would expect restaurant conditions to be placed on the operating schedule if indeed the premises will be more food led. We would suggest the following conditions to be attached to the licence for a restaurant type premises:

1. The supply of alcohol at the premises shall only be to a person seated taking a table meal there and for consumption by such a person as ancillary to their meal.
2. The supply of alcohol shall be by waiter or waitress service only.

If the applicant is looking at a more bar type premises, the Licensing Authority feels that it would be appropriate for food to be made available to the premises to ensure issues concerning intoxication are taken into account. For example, the following condition may wish to be considered:

3. "Substantial food and non-intoxicating beverages, including drinking water, shall be available in all parts of the premises where alcohol is sold or supplied for consumption on the premises"

The prevention of crime and disorder

I have assessed Section 18(b) of Miss Atkinson's application and I have noted that she proposes to have a minimum of 1 door supervisor on Friday and Saturday evenings. However, if the premises is to be more alcohol led with vertical drinking we would advise for there to be a minimum of two. This is so preventative measures are put in place to cover both inside and out of the premises. Furthermore, two SIA door supervisor would also be more effective when dealing with dispersal issues that may arise.

The prevention of public nuisance

We have concerns about the proposed finishing times for Regulated Entertainment on Friday and Saturday going up to 01:00 hours. We feel there is the risk of potential disturbance to residents living nearby. Earlier finishing times may wish to be considered by Miss Atkinson so they are more appropriate for the local area.

The applicant has stated that the closing times will be 30 minutes after the proposed finishing times for licensable activities. However, Ms Atkinson has not addressed the issue of dispersal in the operating schedule.

Public Safety

In addition to the proposals listed in 18(c) of their operating schedule, we feel that the means of escape at the premises should be specifically addressed. For instance, emergency procedures will be important especially with a late night venue where potentially vertical drinking and regulated entertainment will be carried out. The following condition may be considered,

- The means of escape provided for the premises shall be maintained unobstructed, free of trip hazards, be immediately available and clearly identified in accordance with the plans provided.

Recent History

The Council has had to engage with Miss Atkinson at the premises in relation to certain compliance issues.

Firstly, I am aware that on Saturday 19th August 2023 Officers from the Council's Anti-Social Behaviour Team visited the premises due to loud music. Miss Atkinson had submitted a Temporary Event Notice for this event to carry out licensable activities from 18:00 to 00:00 hours for 60 people. During their visit, ASB Officers observed that black bags, chairs and other waste was blocking the rear escape route. They have stated that they entered the complainant's property and concluded that sleep would have been difficult inside and that the bass beat was the dominant sound. As they returned to the premises, they observed that two males were standing at the rear fire door and that they appeared to be smoking what smelt like cannabis openly and unopposed. They noted that two females were sitting on the stairs. One was clearly intoxicated, looking unwell and appeared to have vomited. Officers then went to the front entrance of the premises and reported that there were approximately 15-20 patrons on the street but no sign of a doorman. Officers entered the premises and gained the attention of Miss Atkinson and advised her on the issues. The music was turned down immediately and Officers noted that Miss Atkinson stated that she was unable to deal with everything as she was behind the bar.

Ms Atkinson subsequently applied for a Late Temporary Event Notice on 19th September 2023 for an event scheduled to take place on 30th September 2023. However, Police Licensing submitted a representation against the TEN and therefore our Licensing Team issued a Counter Notice to Miss Atkinson. Following this, I was invited to attend a meeting with Police Licensing and Miss Atkinson on 26th September 2023 at Ruislip Police Station to advise Miss Atkinson's of the areas of concern we had and what was expected from her moving forward.

The incident on 19th August 2023 raises some concerns for us in relation to the confidence we have in Miss Atkinson upholding the licensing objectives in the future if a premises licence were to be granted. Miss Atkinson has applied for a premises licence as an individual and is also the proposed named DPS for this application.

I am happy to attend a hearing, if required, to verbally deliver my representation and also to answer any queries from the Licensing Sub-Committee.

If you have any queries regarding this matter, then please feel free to contact me.



Daniel Ferrer
Licensing Team Manager
dferrer@hillingdon.gov.uk
T. 01895 277 753

RE: New Premises Licence application - Saki, Ruislip Manor

EPTeam <EPTeam@Hillingdon.gov.uk>

Tue 31/10/2023 18:42

To:licensing <licensing@hillingdon.gov.uk>;ASB Investigations <asbinvestigations@hillingdon.gov.uk>;Agnes Forster <AForster@hillingdon.gov.uk>;Amanda Gibbons <agibbons@hillingdon.gov.uk>;Christine Khacherian <CKhacherian@hillingdon.gov.uk>;Navida Khanum <nkhanum@hillingdon.gov.uk>;EPTeam <EPTeam@Hillingdon.gov.uk>; food healthandsafety <foodhealthandsafety@hillingdon.gov.uk>;formsadmin.london@hse.gov.uk <formsadmin.london@hse.gov.uk>;FSR-AdminSupport@london-fire.gov.uk <FSR-AdminSupport@london-fire.gov.uk>;ISD Alcohol Licensing <alcohol@homeoffice.gov.uk>;licensing-xh@met.pnn.police.uk <licensing-xh@met.pnn.police.uk>;Lois King <LKing@hillingdon.gov.uk>;Planning <planning@hillingdon.gov.uk>;Safeguarding children Admin <safeguardingchildrenadmin@hillingdon.gov.uk>;Shikha Sharma <SSharma4@hillingdon.gov.uk>;Trading Standards <tradingstandards@hillingdon.gov.uk>

The EP Team would raise an objection to this application for a new premises licence as we have historic evidence of nuisance and noise complaints from this premises

EP Officers have reported Out-of-Hours (OOH) visits whereby evidence was gathered of patrons smoking inside the premises, contrary to the smoke free legislation, as well as the smoking of drugs to the front and rear of the premises whilst the premises was operational

As well as the smoking offenses witnessed, noise nuisance complaints have been substantiated in the past and verbal / written warnings administered to those persons responsible at the time offence

Given these reasons, we'll await response from the applicant / licensing team to this objection

Kind regards

**Environmental Protection Team**

London Borough of Hillingdon
Civic Centre
High Street
Uxbridge, UB8 1UW



For guidance on Environmental Protection, please visit our webpage: [Environment - Hillingdon Council](#)

Please Note that Public Sector Protective Document Marking is in operation. All sensitive emails and documents originating from Local Authorities should be marked OFFICIAL or OFFICIAL-SENSITIVE. Documents & emails unmarked are to be treated with usual professional courtesy. Those marked OFFICIAL are to be circulated with consideration. Those marked OFFICIAL-SENSITIVE should usually be circulated only to those the author has included in the send field. Secure email will also be used as an additional control measure where applicable for OFFICIAL and OFFICIAL-SENSITIVE external emails.

From: licensing <licensing@hillingdon.gov.uk>

Sent: Wednesday, October 4, 2023 3:35 PM

To: ASB Investigations <asbinvestigations@hillingdon.gov.uk>; Agnes Forster <AForster@hillingdon.gov.uk>; Amanda Gibbons <agibbons@hillingdon.gov.uk>; Christine Khacherian <CKhacherian@hillingdon.gov.uk>; Navida Khanum <nkhanum@hillingdon.gov.uk>; EPTeam <EPTeam@Hillingdon.gov.uk>; food healthandsafety <foodhealthandsafety@hillingdon.gov.uk>; formsadmin.london@hse.gov.uk; FSR-AdminSupport@london-fire.gov.uk; ISD Alcohol Licensing <alcohol@homeoffice.gov.uk>; licensing <licensing@hillingdon.gov.uk>; licensing-xh@met.pnn.police.uk; Lois King <LKing@hillingdon.gov.uk>; Planning <planning@hillingdon.gov.uk>; Safeguarding children Admin <safeguardingchildrenadmin@hillingdon.gov.uk>; Shikha Sharma <SSharma4@hillingdon.gov.uk>; Trading Standards <tradingstandards@hillingdon.gov.uk>

Subject: New Premises Licence application - Saki, Ruislip Manor

Dear Responsible Authorities

LICENSING ACT 2003

As consultees to the licensing process, please be advised that this department has received an application for a new premises licence for the following premises:

Saki
8 Victoria Road
Ruislip Manor
HA4 0AA

The application and supporting documents are attached for your review.

The consultation period will end on 1st November 2023 and any relevant representations to this application must be received by this date. We are unable to accept any representations received after this date or any representations that are not relevant.

Relevant representations need to relate to the one or more of the four licensing objectives, which are:

- Crime and disorder
- Prevention of children from harm
- Public safety
- Prevention of public nuisance.

Please contact the Licensing Service for further information on 01895 277433 or licensing@hillingdon.gov.uk

Regards

Kerry

Licensing Service

London Borough of Hillingdon

3S/08 Civic Centre

High Street

Uxbridge UB8 1UW

tel: internal: 7433

tel: external: 01895 277433



Appendix 3A

From: Cllr Douglas Mills <DMills@Hillingdon.Gov.UK>
Sent: Wednesday, October 18, 2023 2:28 PM
To: Daniel Ferrer <dferrer@hillingdon.gov.uk>
Cc: Cllr Susan O'Brien <SO'Brien@hillingdon.gov.uk>
Subject: Re: License Application - SAKI, 8 Victoria, Ruislip

Daniel,

In respect of the above application, I have been approached by residents who object to this licence being granted.

Please ensure that the committee are aware of these concerns, which are broadly around Prevention of Public Nuisance. There are ongoing matters relating to the adjoining licenced premises, with continued delay and failure to enact measures which would mitigate the noise from both inside and at closing time. This new application therefore has the ability to aggregate the disruption to normal living and thus the accumulation will lead to ongoing and repeated public nuisances.

For completeness, I have included below, the emails from two residents, (in their own words).

Cllr Douglas Mills

I would like to make an objection to the application for a Premises Licence at the address *Saki, Unit 2, 8 Victoria Road, Ruislip, HA4 0AA*. On the front door of the premises there is a Notice of Application which details the proposed licensing hours in relation to Live Music, Recorded Music and Late Night Refreshment, including the sale of alcohol, up until midnight Sunday to Thursday and up until 1am Friday to Saturday. As one of the residents living directly above the premises I feel that the licence is inappropriate and would cause considerable disturbance to residents in the area. My opinion is founded on recent and past experiences, some of which I detail below.

My experience with Saki dates back to 2022 where in the early hours of Sunday 24th July there was loud music playing from the premises up until around 5am. Another incident more recently on Saturday 19th August involved large numbers of people entering the premises, drinking alcohol openly in the street, bottles being thrown and very loud music being played which caused several residents distress, some of whom went down to speak to the people there. I also know from other residents that the applicant listed was confronted on this day in question about the noise and said she didn't care about the residents and she was trying to run a business. If this is how the applicant acts prior to an application for a licence, one can only imagine it will be worse should the licence be granted.

Pursuant to the Environmental Protection Act 1990 and Noise Act 1996, I would like to bring to your attention the separate situation which is still ongoing with the adjacent property 10 Victoria Rd and therefore any newly permitted license to this said property would result in the same issues arising.

My main concerns after reviewing the terms of the permit are the live music and the operating timings proposed. Due to this and the lack of adequate sound proofing installed, I would not be able to enjoy the tranquillity of my home especially on weekends when it is proposed to last all day until the early hours of the morning.

Separately, I also have grave concerns regarding the permitted smoking area, which is currently at the front of the property directly on the High Street. Upon the award it would leave 3 late night restaurant/bars directly in a row, all of which having well over 100+ people as their capacity. This in turn would lead to a large congregation of people outside and would cause, along with the noise levels generated, severe disturbance to my dwellings ambience.

Daniel Ferrer

From: Conor Donegan [REDACTED]
Sent: 13 October 2023 10:58
To: licensing
Cc: Daniel Ferrer; Cllr Douglas Mills
Subject: Objection to Notice of application for a Premises Licence

Follow Up Flag: Follow up
Flag Status: Flagged

Hello Licensing team,

I would like to make an objection to the application for a Premises Licence at the address *Saki, Unit 2, 8 Victoria Road, Ruislip, HA4 0AA*. On the front door of the premises there is a Notice of Application which details the proposed licensing hours in relation to Live Music, Recorded Music and Late Night Refreshment, including the sale of alcohol, up until midnight Sunday to Thursday and up until 1am Friday to Saturday. As one of the residents living directly above the premises I feel that the licence is inappropriate and would cause considerable disturbance to residents in the area. My opinion is founded on recent and past experiences, some of which I detail below.

My experience with Saki dates back to 2022 where in the early hours of Sunday 24th July there was loud music playing from the premises up until around 5am. Another incident more recently on Saturday 19th August involved large numbers of people entering the premises, drinking alcohol openly in the street, bottles being thrown and very loud music being played which caused several residents distress, some of whom went down to speak to the people there. I also know from other residents that the applicant listed was confronted on this day in question about the noise and said she didn't care about the residents and she was trying to run a business. If this is how the applicant acts prior to an application for a licence, one can only imagine it will be worse should the licence be granted.

Whilst I understand and respect an individual's right to start a business in the local area, I feel that the type of business and previous conduct of the applicant/premises makes this application inappropriate and unreasonable for residents in the local area. Thank you for noting my comments down here.

Kind regards,
Conor Donegan

Ms Marian Mills
10a Victoria Rd
Ruislip Manor
Middlesex
HA4 0AA

License Services
London Borough of Hillingdon
Civic Centre
High Street
Uxbridge
UB10 1UW

17th October 2023

Dear whomever it may concern,

I am writing in response to the Licensing Act 2003 notification (*refer to Appendix 1*) which has been displayed by Miss Charlotte Elizabeth Atkinson at 8 Victoria Rd, Ruislip Manor HA4 0AA and would like to formally object to such license being granted for these premises, due to the statutory nuisance any award would cause to myself, neighbours and our dwellings.

Pursuant to the Environmental Protection Act 1990 and Noise Act 1996, I would like to bring to your attention the separate situation which is still ongoing with the adjacent property 10 Victoria Rd and therefore any newly permitted license to this said property would result in the same issues arising.

My main concerns after reviewing the terms of the permit are the live music and the operating timings proposed. Due to this and the lack of adequate sound proofing installed, I would not be able to enjoy the tranquillity of my home especially on weekends when it is proposed to last all day until the early hours of the morning.

Separately, I also have grave concerns regarding the permitted smoking area, which is currently at the front of the property directly on the High Street. Upon the award it would leave 3 late night restaurant/bars directly in a row, all of which having well over 100+ people as their capacity. This in turn would lead to a large congregation of people outside and would cause, along with the noise levels generated, severe disturbance to my dwellings ambiance.

I hope the enclosed information clearly outlines my concerns and opposition to the award, but if required, I would be prepared to attend in person any hearings to discuss the matter further.

Yours sincerely,

Marian Mills

APPENDIX I:

**LONDON BOROUGH OF HILLINGDON
NOTICE OF APPLICATION FOR A PREMISES LICENCE -
LICENSING ACT 2003**

APPLICANT: MISS CHARLOTTE ELIZABETH ATKINSON

PREMISES: SAKI, UNIT 2, 8 VICTORIA ROAD, RUISLIP, HA4 0AA

The proposed licensable activities are:

- **Live Music, Recorded Music, Performance of Dance,
Retail Sale of alcohol (On Sales):
Sunday – Thursday: 11:00 – 00:00, Friday – Saturday: 11:00 – 01:00**
- **Late Night Refreshment:
Sunday – Thursday: 23:00 – 00:00, Friday – Saturday: 23:00 – 01:00**

Full details of the application can be inspected at the address noted below during normal business hours. Any representations by an interested party or responsible authority regarding this application can be made to:

**The Licensing Services
London Borough of Hillingdon
Civic Centre
High Street
Uxbridge
UB8 1UW**

Website: www.hillingdon.gov.uk

Tel: 01895 277433

Such representation must be received in writing to above address or by email: licensing@hillingdon.gov.uk by: **01/11/2023** clearly stating the grounds upon which the representation is made in relation to the four objectives of the Licensing Act 2003.

It is an offence to knowingly or recklessly make a false statement in connection with an application. The maximum fine for which a person is liable on summary conviction for the offence is unlimited.

Daniel Ferrer

From: [REDACTED]
Sent: 19 October 2023 21:37
To: licensing
Subject: RE: Licence Application/ SAKI, Unit 2, 8 Victoria Road, Ruislip, HA40AA

You don't often get email from agacicha1981@gmail.com. [Learn why this is important](#)

Samir Yanina
6A Victoria Road
Ruislip, HA4 0AA

[REDACTED]
19/10/2023

Licensing Team
London Borough of Hillingdon
Civic Centre
High Street
Uxbridge
UB8 1UW

Subject: Objection to Premises Licence Application -MISS CHARLOTTE ELIZABETH ATKINSON for SAKI, UNIT 2, 8 VICTORIA ROAD, RUISLIP, HA4 0AA

Dear Members of the Licensing Team,

I am writing to formally express my strong opposition to the premises licence application submitted by MISS CHARLOTTE ELIZABETH ATKINSON for the proposed activities of live music, performance of dance, and retail sale of alcohol, at the premises located at SAKI, UNIT 2, 8 VICTORIA ROAD, RUISLIP, HA4 0AA.

I am a resident living above the aforementioned premises, and I have grave concerns regarding the potential adverse impacts this licence may have on my quality of life and the safety of my family. My objections are as follows:

- 1.**Late Night Noise**:** Given the extended operating hours. I am deeply concerned about the significant increase in noise levels during unsociable hours, particularly late into the night. This would undoubtedly disrupt the peaceful enjoyment of our home and hinder our ability to rest adequately.
- 2.**Intoxicated Customers**:** Allowing the sale of alcohol until midnight raises the very real possibility of patrons leaving the premises in an intoxicated state. This creates a potential safety hazard, not only for residents in close proximity but also for the general public.
- 3.**Impact on Schoo;-Age Children**:** I have two young children, [REDACTED], who are at a crucial stage in their schooling. The proposed activities and potential disturbances in the vicinity would undoubtedly impede their ability to focus on their studies, adversely affecting their educational progress.
- 4.**Audible Disruption**:** The nature of the activities applied for means that sound travels easily through our building. Live music and dance performances would be readily audible in all flats above the premises, further compounding the issue of noise pollution.

5.** Previous Incidents and Council Action** : It is pertinent to note that the local council has previously intervened due to noise pollution issues stemming from the applicant's property. This demonstrates a history of disturbances that are likely to persist should this licence be granted. Reference numbers 50603, 44750 and 42637.

6.**Case Order Against Applicant** : The fact that there is an existing case order against the applicant further raises concerns about the ability to responsibly manage the licensed activities and mitigate potential nuisances. Reference number 6373/7912/8060/2236.

In light of the above, I respectfully request that the Licensing Committee carefully consider my objections and take them into account when evaluating this application. I firmly believe that granting this licence would be detrimental to the well-being and safety of my family and other residents in the vicinity.

I appreciate your attention to this matter and trust that you will make a decision in the best interest of the community.

Thank you for your time and consideration.

Sincerely,
Samir Yanina

From: [Emma Flack](#)
To: licensing@hillingdon.gov.uk
Subject: License notification for Saki
Date: 17 October 2023 21:11:25

To whom it may concern,

We are writing in response to the Licensing Act 2003 notification which has been displayed by Miss Charlotte Elizabeth Atkinson in relation to Saki, Unit 2, 8 Victoria Road, Ruislip. As residents who live close to these premises, we formally object to the extended opening, music and licencing hours which have been applied for, due to longstanding issues in the area with noise and anti-social behaviour.

There are currently several establishments within close proximity that are licensed to be closed no later than 12am and there have been issues with anti-social behaviour, fighting, under-age drinking, drugs, noise nuisance, urination in outdoor spaces and litter, and we are in no doubt these issues will escalate should this license application be successful. When these issues have affected us, we have reported and logged them with Hillingdon Council. We have lived here for nearly 3 years and have had to do this far too many times already. There have been times we have felt unsafe in our own home, and when we have not been able to sleep due to noise from music and people being outside the restaurants and bars late at night. This has a very negative impact on our wellbeing.

It is worth noting that Saki share the back yard/car parking area with the Real Love Lounge, Ten Restaurant and Wetherspoons, and extended hours will, in all likelihood, allow these issues to escalate further should businesses in the area be allowed to trade later. It was on these grounds that Ten Restaurant was not granted an extended license in 2021. We understand that some of our neighbours already have problems with the music that is played in Saki (particularly the neighbours that live directly above) so an extension of their hours will only exacerbate things.

In addition, by agreeing to allow Saki to serve alcohol and play music later, it will set a dangerous precedent for the other businesses close by to apply to extend their licenses. Wetherspoons does have a license until 1am on weekends; notably they do not play music which is one benefit, but their trading hours do cause disruption and there is certainly no appetite for other businesses to follow suit and drag the area into the gutter.

We appreciate you taking the time to read our views and hope these concerns are taken as seriously as they are intended. There are a range of families that reside in this block, including the elderly and those with young children, and we feel it would be inappropriate to extend the licensing hours for any restaurant or bar in the area.

Kind regards,
Dr Emma Flack & Mr Benjamin Raywood
112A Pembroke Rd,
Ruislip,
HA4 8NW

From: nishma.b
To: licensing@hillingdon.gov.uk
Cc: [REDACTED]
Subject: Licence for Unit 2 8 Victoria Road Ruislip HA4 0AA
Date: 01 November 2023 23:30:50

[You don't often get email from [REDACTED] Learn why this is important at <https://aka.ms/LearnAboutSenderIdentification>]

Dear Sirs,

It has come to my attention that a licence has been submitted for the above property for a restaurant and bar.

Having looked at the application I note that the licence request is till 12am Sunday to Thursday and 1am Friday and Saturday. I also note that there is to be music and a provision for dancing at the venue.

I am one of the owner of the property 6a Victoria Road and I strongly feel that the grant of such licence will have an impact on the value of my property and impact my right to quiet enjoyment of my property.

I note that there is no provision for sound proofing and I am very concerned that the sound of music being played till 1am will have negative impact on my property.

There is already a Weatherspoons and a restaurant/bar next to this site which already brings enough footfall, adding a similar establishment will be detrimental to the area.

I look forward to hearing from you.

Kind Regards
Nishma Parmar, Aarti Babber, Suman Bhadresa and Kusum Bhadresa

Sent from my iPhone

The Licensing Services
London Borough of Hillingdon
Civic Centre
Uxbridge
UB8 1UW

November 1, 2023

Re: Miss Charlotte Elizabeth Atkinson – Saki, Unit 2, 8 Victoria Road, Ruislip, HA40AA

To the Licensing Team,

I am one of the residents living above the Saki business. They are currently applying for a license to offer the following services:

- **Live Music, Recorded Music, Performance of Dance**
- **Retail Sale of Alcohol (On Sales):**
 - **Sunday – Thursday: 11:00 AM – 12:00 AM**
 - **Friday – Saturday: 11:00 AM - 01:00 AM**
- **Late Night Refreshment:**
 - **Sunday – Thursday: 11:00 PM – 12:00 AM**
 - **Friday – Saturday: 11:00 PM – 01:00 AM**

I support the idea of businesses developing and growing, as I believe it can have a positive impact on the community. However, over the past year, Saki has already been operating and providing alcohol along with playing music, which has been very disturbing for the local residents living above their premises. I was initially under the impression that Saki already held a license for playing music, dancing, alcohol consumption, and light refreshments.

Since this hasn't been the case, there has been no consideration for noise control for the residents living above this new startup business.

This leads me to the issue of **waste mismanagement**, with waste being left outside in the car park area and up the stairs at the back of the doors for No Ten Restaurant and Saki. The waste left outside the business **attracts vermin and emits odours, creating an extremely unhygienic and messy environment.**

The presence of this waste has attracted vermin, such as rats, foxes, and pigeons, which have left excrement in our front gardens and doorsteps.

During Saki's refurbishment, machinery has been placed right outside fire exits and stairwells, posing a significant health and safety risk, especially for my elderly mother, who struggles to manoeuvre around this machinery.

There was no consideration for us residents when work was being carried out by Saki in regards to parking, which forced residents to park our vehicles on the roadside.

It would have been appreciated if Saki had informed us residents and local businesses about this in advance, as well as the expected duration for the skip's placement within the car park area. This caused significant problems and complications for all local businesses and residents on Victoria/Pembroke Road.

Saki's management team has shown no care, consideration, or respect for any of the residents or local businesses. While some friendly interactions have occurred, no actions have been taken to address the issues.

While a few of the employees greet us residents with "Hi, how are you doing," I don't believe the business will show care or consideration for what happens when customers leave the establishment intoxicated, potentially causing disturbances, noise, and even anti-social behaviour.

Saki has demonstrated over the year that they lack care or consideration for their neighbours, which leads me to believe that there will be significant problems in the community going forward when issues arise.

There is a lack of diplomacy, tact, respect, or even basic communication skills that would assure me, the residents, and local businesses that they can professionally and promptly handle and address these issues while safeguarding all civilians and residents.

Regrettably, I must appeal against this application, as I foresee all of the above issues persisting based on how the residents have been treated by Saki over the past year. It's unfortunate because I was looking forward to spending time within their establishment.

Yours sincerely,

Akwesi Penemo 2a Victoria Road

This page is intentionally left blank

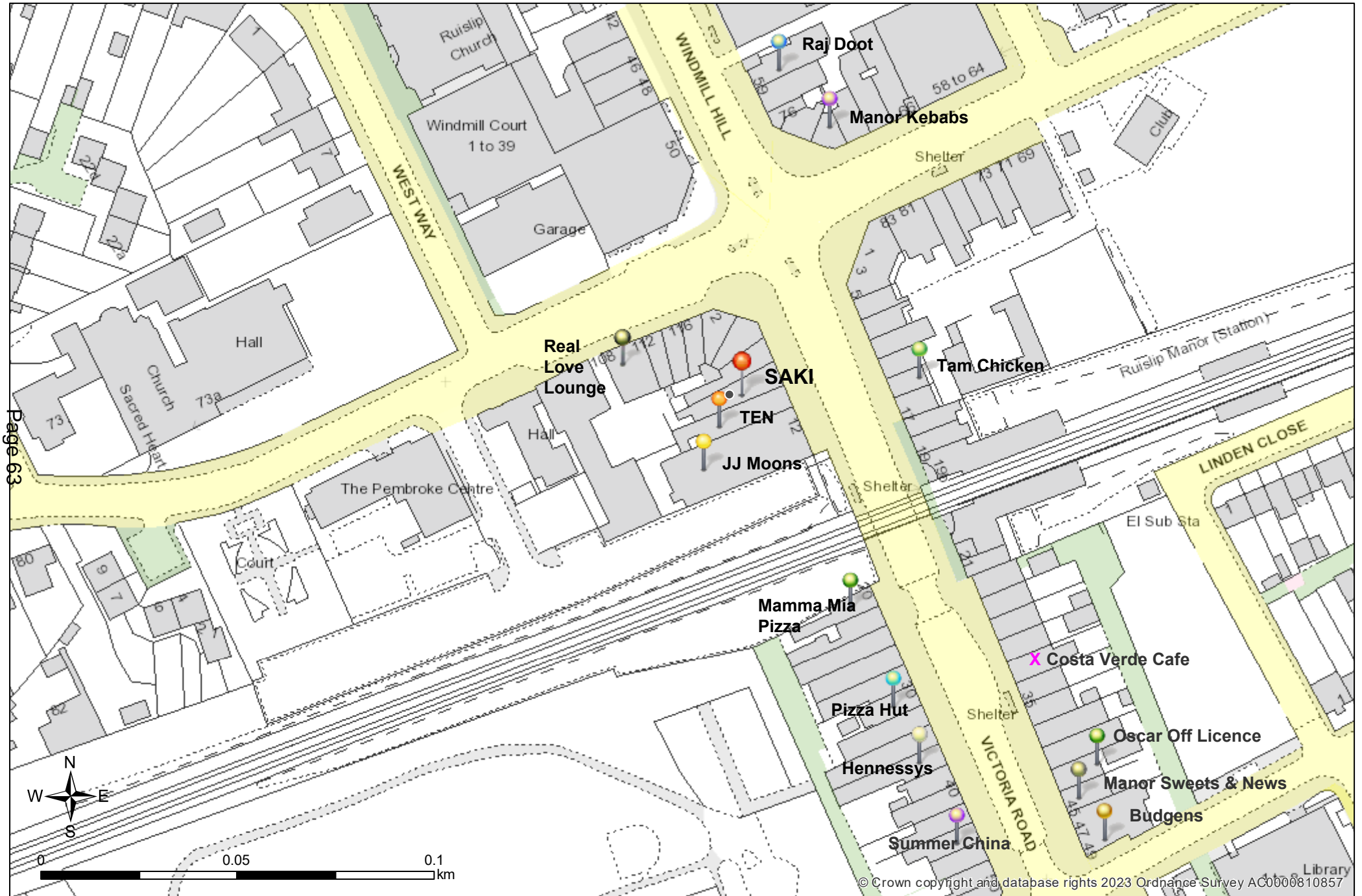

Page 63

This page is intentionally left blank



